

Copyright State of Victoria. No part of this publication may be reproduced except as permitted by the Copyright Act 1968 (Cth), to comply with a statutory requirement or pursuant to a written agreement. The information is only valid at the time and in the form obtained from the LANDATA REGD TM System. None of the State of Victoria, its agents or contractors, accepts responsibility for any subsequent publication or reproduction of the information.

The Victorian Government acknowledges the Traditional Owners of Victoria and pays respects to their ongoing connection to their Country, History and Culture. The Victorian Government extends this respect to their Elders, past, present and emerging.

REGISTER SEARCH STATEMENT (Title Search) Transfer of Land Act 1958

VOLUME 03193 FOLIO 521

Security no : 124093738139W  
Produced 15/11/2021 02:40 PM

LAND DESCRIPTION

Road R1 on Plan of Subdivision 005344.  
PARENT TITLE Volume 01279 Folio 619  
Created by instrument 1230596R 15/04/1907

REGISTERED PROPRIETOR

Estate Fee Simple  
Sole Proprietor

NATIONAL TRUSTEES EXECUTORS AND AGENCY COMPANY OF AUSTRALASIA LTD of 454  
COLLINS STREET MELBOURNE VIC 3000 Legal Personal Representative(s) of DENIS  
WADICK deceased  
1230596R 15/04/1907

ENCUMBRANCES, CAVEATS AND NOTICES

Any encumbrances created by Section 98 Transfer of Land Act 1958 or Section 24 Subdivision Act 1988 and any other encumbrances shown or entered on the plan or imaged folio set out under DIAGRAM LOCATION below.

DIAGRAM LOCATION

SEE LP005344 FOR FURTHER DETAILS AND BOUNDARIES

ACTIVITY IN THE LAST 125 DAYS

NIL

DOCUMENT END

Delivered from the LANDATA® System by InfoTrack Pty Ltd.

The information supplied by Infotrack has been obtained from InfoTrack Pty Limited by agreement between them. The information supplied has been obtained by InfoTrack Pty Limited who is licensed by the State of Victoria to provide this information via LANDATA® System.

© State of Victoria. This publication is copyright. No part may be reproduced by any process except in accordance with the provisions of the Copyright Act 1968 (Cth) and for the purposes of Section 32 of the Sale of Land Act 1962 or pursuant to a written agreement. The information is only valid at the time and in the form obtained from the LANDATA® System. None of the State of Victoria, LANDATA®, Victorian Land Registry Services Pty. Ltd. ABN 86 627 986 396 as trustee for the Victorian Land Registry Services Trust ABN 83 206 746 897 accept responsibility for any subsequent release, publication or reproduction of the information.

PLAN OF SUBDIVISION OF  
PART OF CROWN ALLOTMENTS 2&3  
AT RICHMOND  
PARISH OF JIKA JIKA

COUNTY OF BOURKE  
VOL 3193 FOL 521

Measurements are in Feet & Inches  
Conversion Factor  
FEET x 0.3048 = METRES

LP5344

EDITION 2

PLAN MAY BE LODGED  
10 - 10 - 1910

COLOUR CODE

- E-1 = YELLOW
- R1 = BROWN
- E-3 = PURPLE
- E-4 = GREEN
- E-5 = BLUE
- E-6 = PURPLE HATCHED
- E-7 = YELLOW HATCHED

ROADS COLOURED BROWN

STREET NAME AMENDED

FROM : DOVE STREET  
TO : STEPHENSON STREET  
VIDE : GAZ 1960 P 399

ENCUMBRANCES

AS TO THE LAND COLOURED BROWN  
ANY EASEMENTS AFFECTING  
THE SAME.

NOTATION

DEPTH LIMITATION 15.24 METRES  
BELOW THE SURFACE PURSUANT  
TO SEC. 67(2) MELBOURNE CITYLINK  
ACT. 1995 V433144V.

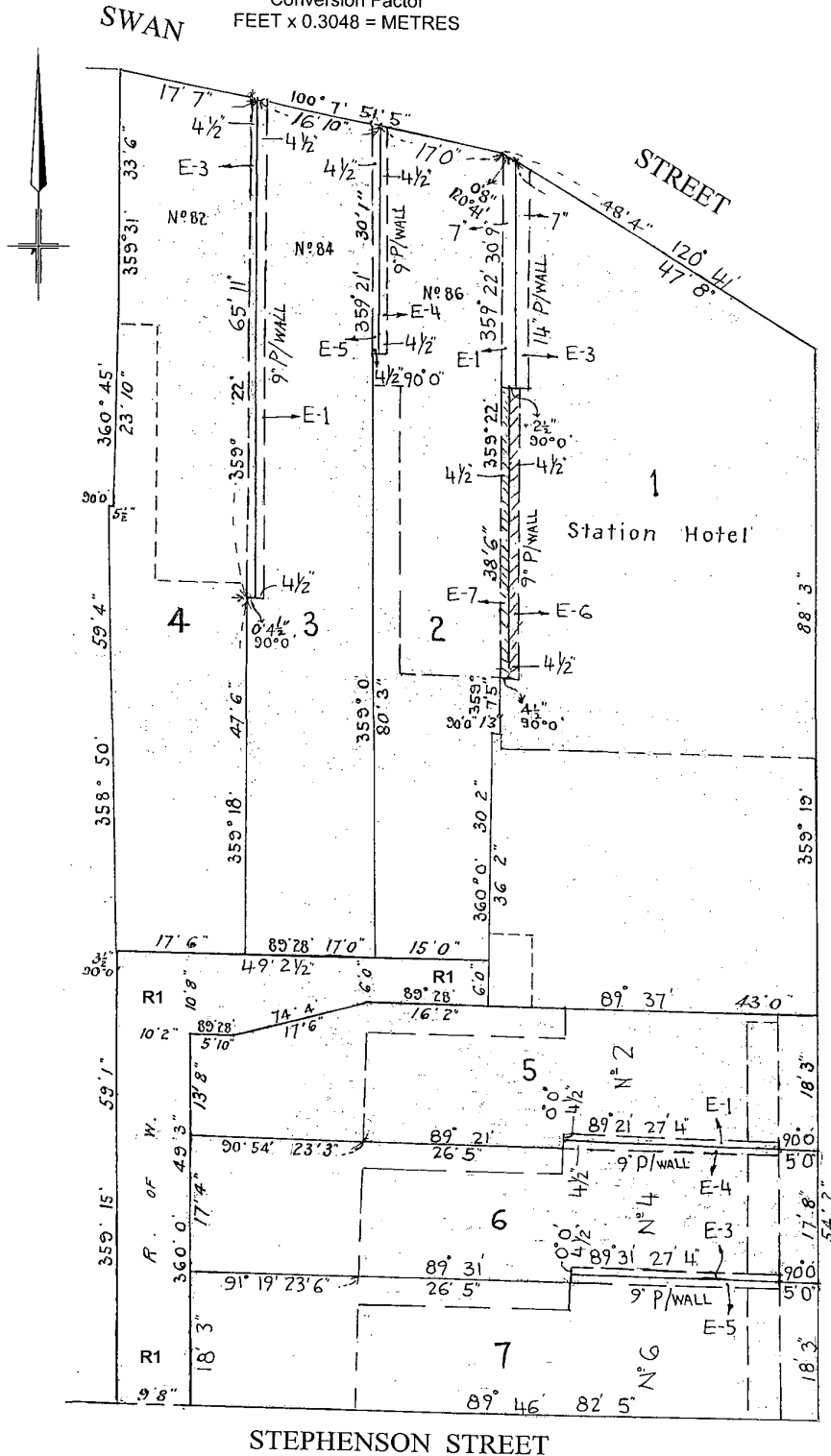

DOVER STREET

STEPHENSON STREET

