

**RE:-** Cambridge Street, Collingwood.

**PROPERTY:-** Part Crown Portions. 52 & 53, Parish of Jika Jika.

**YOUR REF:-** JKOZ:8776306

A search for the **Last Registered Owner** of the above property resulted with copies of the following:-

1. L.A.S.S.I. For Current Map Base Information.
2. TITLES OFFICE CHART  
Jika Jika 72
3. CONVEYANCE  
Bk: F No: 262 to C. HUTTON. (**Last Registered Owner**)
3. PLAN IN APPN:  
389 Showing the Land remaining in the above Conveyance
4. 26F:- NIL, see sheet attached.

17.11.2021

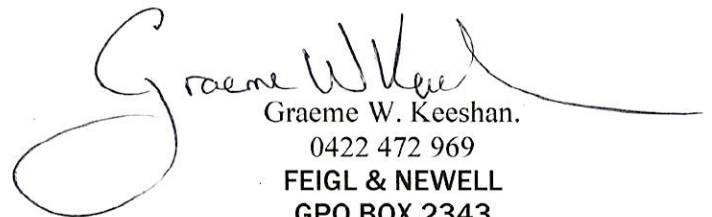

Graeme W. Keeshan.

0422 472 969

FEIGL & NEWELL

GPO BOX 2343

Melb 3001

Ph. 9629 3011.

Email. [info@feiglnewell.com.au](mailto:info@feiglnewell.com.au)

**DISCLAIMER:-** A search for the last registered owner may not disclose all easements, subsisting interests affecting the above property or guarantee the consistency of the Chain of Title.

Due to changes in procedures at the Lands Titles Office, this search is as accurate as the information contained herein at the date of this search.



Data Source: Vicmap Property

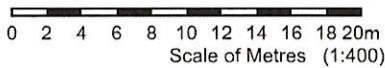

MGA Zone 55  
Melways- 2C E11 (ed.42) Vicroads- 437 C8 (ed.8)  
Created 02:07 PM on Nov 24, 2021

Co-ordinates of Plot Corners  
NW 322613,5813890  
SW 322615,5813800  
MGA Zone 55

**WARNING:**  
No warranty is given as to the accuracy or completeness of this map.  
Dimensions are approximate.  
For property dimensions, undertake a Title search.

Co-ordinates of Plot Corners  
NE 322685,5813891  
SE 322687,5813802  
MGA Zone 55

PEEL

STREET

22

AR75654 S.26D

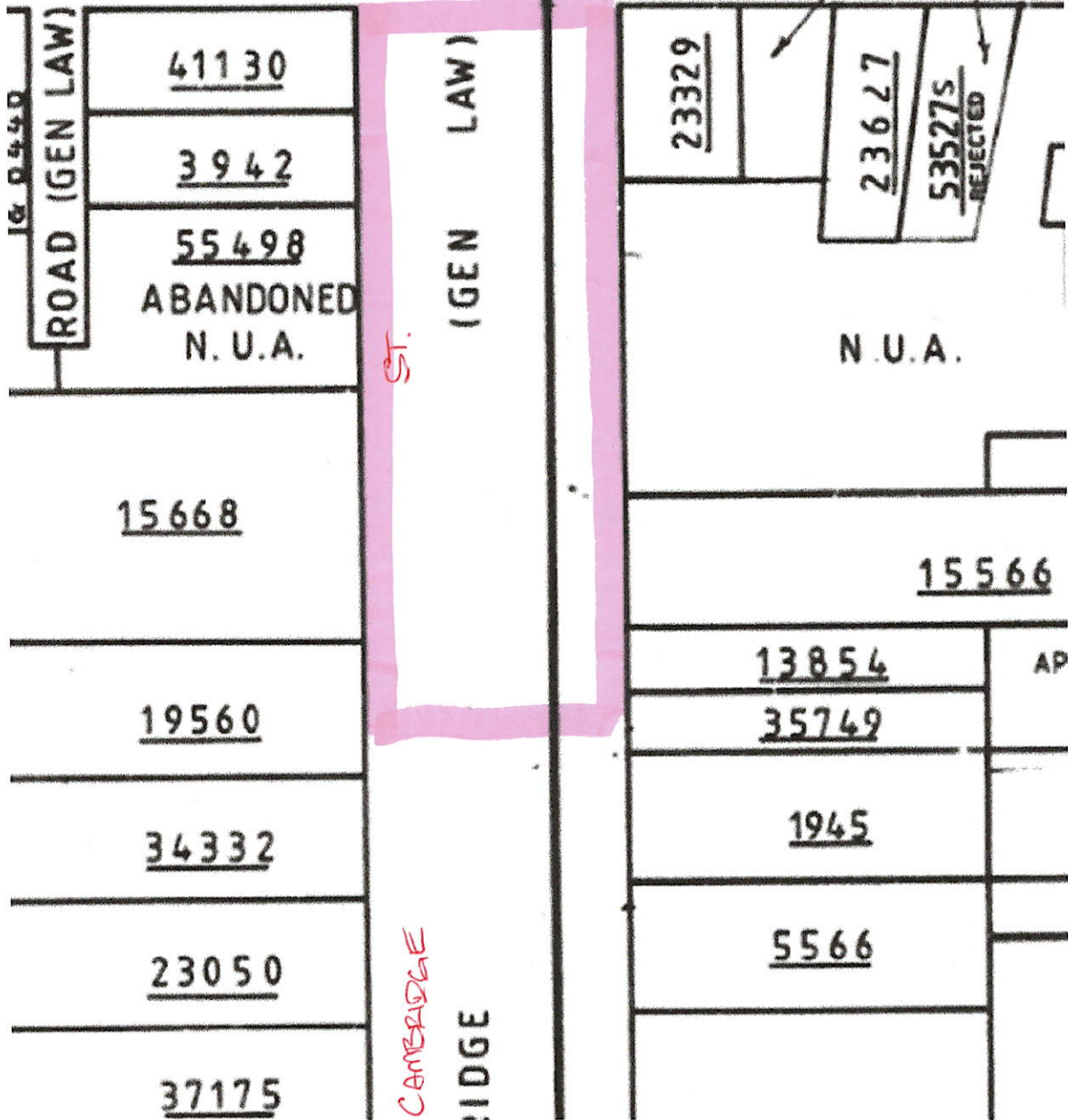

Jika Jika Chart. 72.



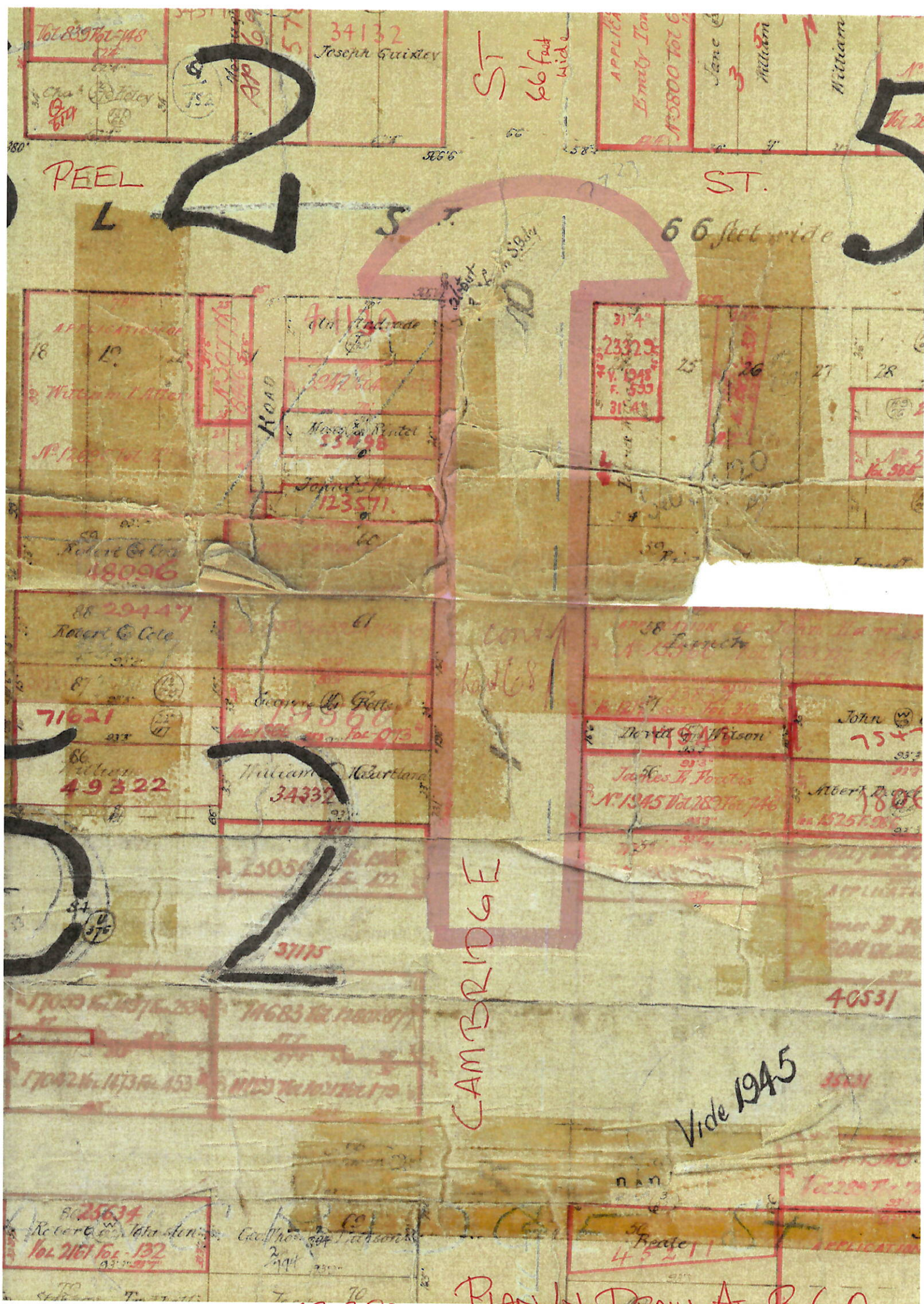

AP. 389.

PLAN IN DRAW AT R.G.O.

Vide 1945

DUNEED			C/A A (Pt) POR 5	AP126614J	104423	AH281278X	1/PS644554M	8/6/2010
ELPHINSTONE		CA 11A SEC 3	CA 11A SEC 3	AP123501P	93211	PS522874Y	TP845311G	26/8/2004
GHERINGHAP		CA'S 3 & 4 SEC 14	CA'S 3 & 4 SEC 14	AP120136C	108560 &116294	V886761W	TP13776A	10/2/1999
HARCOURT		(PART)CA 2 SEC 5	(PART)CA 2 SEC 5	AP123982T	93227	AD657946X	TP858569R	02/06/2005
HARCOURT		1 (WH) & 2 (PT) SEC 4	1 (WH) & 2 (PT) SEC 4	AP128068Y	93252/3	AJ824135G	TP950358R/9P	30/7/2012
HARCOURT		CA 1 (Pt) SEC 6	CA 1 (Pt) SEC 6	AP125348J	C.G.30094(1854)	PS608456R	TP915757A	28/9/2007
HARCOURT		CA 27 SEC 4	CA 27 SEC 4	AP128073G	93263	AJ825929L	TP950363Y	30/7/2012
JIKA JIKA		PORT 49 (PT)	PORT 49 (PT)	AP131456V	BK B NO 280	AL411777Y	TP955996E	09/10/2014
JIKA JIKA		PORT 52 (PART)	PORT 52 (PART)	AP127218M	111667	AJ64154M	TP948278C	12/7/2011
JIKA JIKA CITY OF NORTHCOTE		C/A 12(Pt) SEC 9	C/A 12(Pt) SEC 9	AP138035J	112184	AN694016A	TP962456Y	30/3/2017
JIKA JIKA AT NTH MELB		C/ALLOTS 12,13,14 (PTS)	C/ALLOTS 12,13,14 (PTS)	AP141375P	C/G 3205,6,7 OF 1852	PS818927F	TP965686P	21/06/2018
T/P KALKALLO		C/A's 4 & 5 SEC 2	C/A's 4 & 5 SEC 2	AP126717X	CGs521/2 1853		TP946393N	13/8/2010
T/P KALKALLO		C/A'S 2,3,4,5,6,7,8,10 (ALL PART) SEC 6	C/A'S 2,3,4,5,6,7,8,10 (ALL PART) SEC 6	AP126722F	VARIOUS STARTS FROM AP46336		TP946401S	13/8/2010
T/P KALKALLO		C/A 9 SEC 25	C/A 9 SEC 25	AP126721H	115430		TP946397E	13/8/2010
KORKUPERRIMUL		PORT 11 (PART)	PORT 11 (PART)	AP125581C	81743	AF722885N	TP924161K	18/3/2008
LANGI-GHIRAN		C/A 2 (PT) SEC 32	C/A 2 (PT) SEC 32	AP132892T	97263	AL959658A	TP957658Q	16/06/2015
LARA		PORT 16	PORT 16	AP122312X	-	AB734381L	TP820035U	3/12/2002
LAURISTON		CA 303	CA 303	AP121724D	80888	AB8511B	TP800321G	8/1/2002
LAURISTON				AP121725B	80888	AB8526M		8/1/2002
MALDON		CA 19 SEC B	CA 19 SEC B	AP124439L	91307	AB66829N & AF260857R	TP873975T	16/12/2005
MELBOURNE NORTH CITY OF MELBOURNE		CA 1(Pt) & CA 20(Pt) SEC 43	CA 1(Pt) & CA 20(Pt) SEC 43	AP134983E	-	PS 746078A	TP959898H	02/05/2016
MARIBRYNONG		POR B SEC 2 (PT)	POR B SEC 2 (PT)	AP119117P	CG 26798	AH462111E	TP945836K	9/6/2010
MELBOURNE SOUTH CITY OF PORT MELBOURNE		C/A 1 (PART) SEC 5	C/A 1 (PART) SEC 5	AP128053N	TOWN LOT 2141 (1851)	AJ807003W AJ906120Q	TP950332L	20/7/2012
CITY OF SOUTH MELBOURNE (MELBOURNE SOUTH)		C/A 1(Pt) & 2(Pt) SEC 23	C/A 1(Pt) & 2(Pt) SEC 23	AP128831P	114713	AK259717X	TP951705R	27/3/2013
MERIDITH		POR 86	POR 86	AP126694H	81548	AH408067L	TP946354Y	5/8/2010
MERRIMU T-SHIP OF BACCHUS MARSH	AM50480A (X106C)	POR 11 SEC 15 (Pt)	POR 11 SEC 15 (Pt)	AP126842U	Bk T No 517	AH599268D <b>REMOVED</b>	TP946821T	8/11/2010
MICKLEHAM		POR 11B (Pt)	POR 11B (Pt)	AP127891A	CG 25247/1852		TP950083F	6/6/2012
MONEA SOUTH		C/A 21 (FORMERLY C/A 21 SEC 2)	C/A 21 (FORMERLY C/A 21 SEC 2)	AP128067B	106467	AJ819028M	TP950352E	26/7/2012