

<b>TITLE PLAN</b>		<b>EDITION 1</b>	<b>TP</b>
<b>LOCATION OF LAND</b> PARISH: JIKA JIKA TOWNSHIP: — SECTION: — CROWN PORTION: 8 (PART)		<b>NOTATIONS</b>  	
<b>MGA CO-ORDINATES:</b> E 323 970 ZONE: 55 <small>(of approximate centre of land in plan)</small> N 5 811 570 GDA 2020 <b>DEPTH LIMITATION:</b> DOES NOT APPLY		THIS PLAN HAS BEEN PREPARED FOR LAND VICTORIA FOR TITLE DIAGRAM PURPOSES.	CHECKED BY: ..... DATE: / / <small>Assistant Registrar of Titles</small>

<b>EASEMENT INFORMATION</b>				
<b>LEGEND:</b> A - APPURTENANT EASEMENT E - ENCUMBERING EASEMENT R - ENCUMBERING EASEMENT (ROAD)				
EASEMENT REFERENCE	PURPOSE	WIDTH (METRES)	ORIGIN	LAND BENEFITED /IN FAVOUR OF
E-1	AS PROVIDED FOR IN SEC. 207C LGA 1989	SEE DIAG.	SEC 207C LGA 1989	GREATER WESTERN WATER CORPORATION

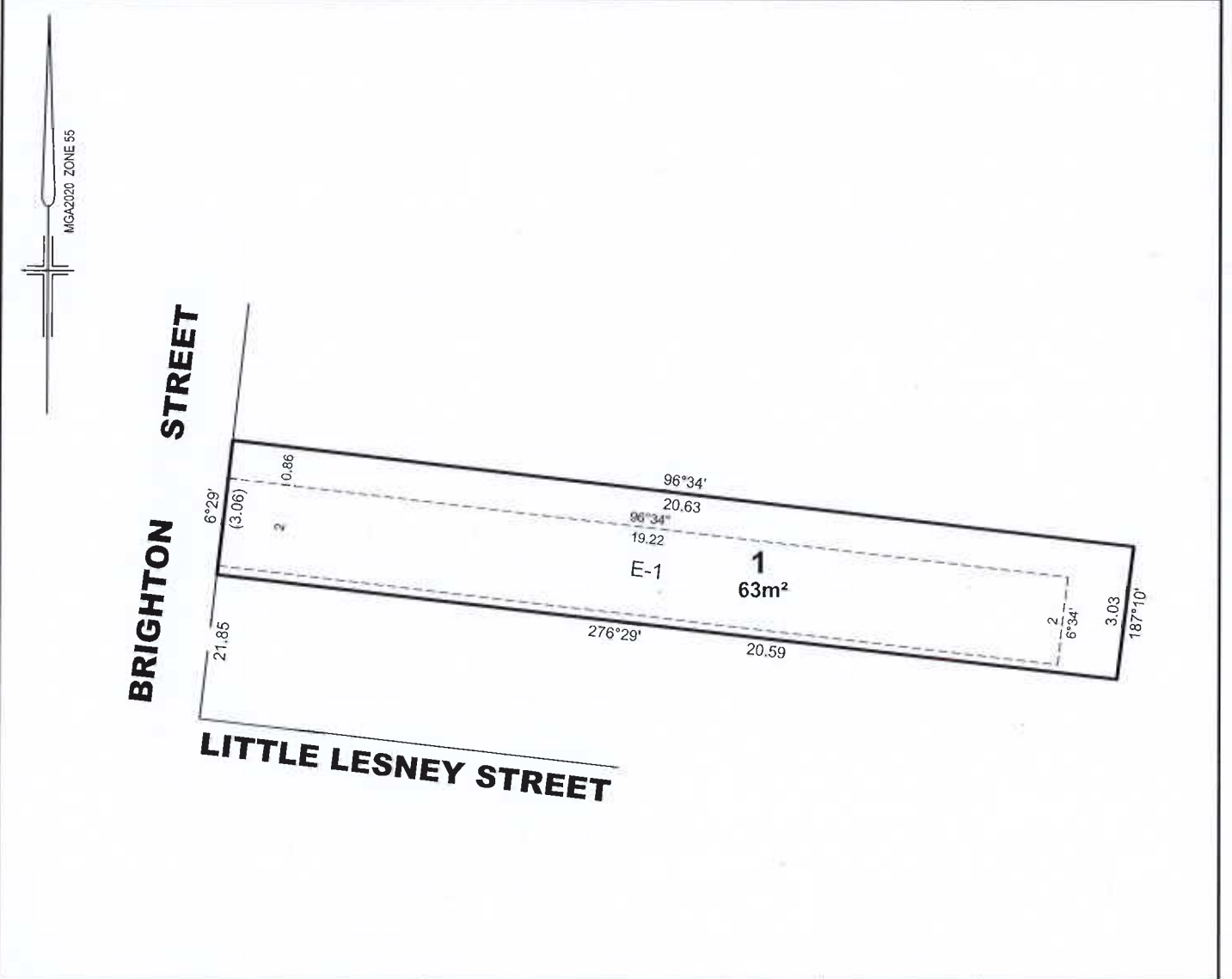

REF: 23894	VERSION: A	DATE: 15/11/21 23894-0-TP-A.DGN	SCALE: 1:100 	ORIGINAL SHEET SIZE A3	SHEET
<b>REEDS CONSULTING</b> <small>Reeds Consulting Pty Ltd          Lvl 6, 440 Elizabeth Street          Melbourne Victoria 3000          p (03) 8660 3000          www.reedsconsulting.com.au          survey@reedsconsulting.com.au</small>			LICENSED SURVEYOR <b>ALAN DAVID NORMAN</b>		GOVERNMENT GAZETTE No.: DEALING/FILE No.: DEALING CODE: