

TITLE PLAN

EDITION I

LOCATION OF LAND

PARISH : JIKA JIKA AT NORTH FITZROY
 TOWNSHIP : _____
 SECTION : 42
 CROWN ALLOTMENT: 3 (PART)
 CROWN PORTION : _____
 LAST PLAN REFERENCE : ROAD R-1, TP.923859V
 TITLE REFERENCE : VOL.772 FOL.273 (PART)

NOTATIONS

DEPTH LIMITATION DOES NOT APPLY
 CONNECTION SHOWN TO SCOTCHMER STREET IS NOT TO SCALE

MGA.2020 Co-ordinates (of approx. E 322 475 ZONE: 55
 (of approx. centre of land in plan) N 5 816 135 GDA 2020

EASEMENT INFORMATION

LEGEND A - Appurtenant Easement E - Encumbering Easement R - Encumbering Easement (Road)

	Purpose	Width (Metres)	Origin	Land Benefited/In Favour Of
E-1	AS PROVIDED FOR IN SEC.207C LGA 1989	2.00	SEC.207C LGA 1989	CITY WEST WATER

THIS PLAN HAS BEEN PREPARED FOR LAND USE VICTORIA FOR TITLE DIAGRAM PURPOSES

Checked by:

Date:

Assistant Registrar of Titles

SCOTCHMER STREET

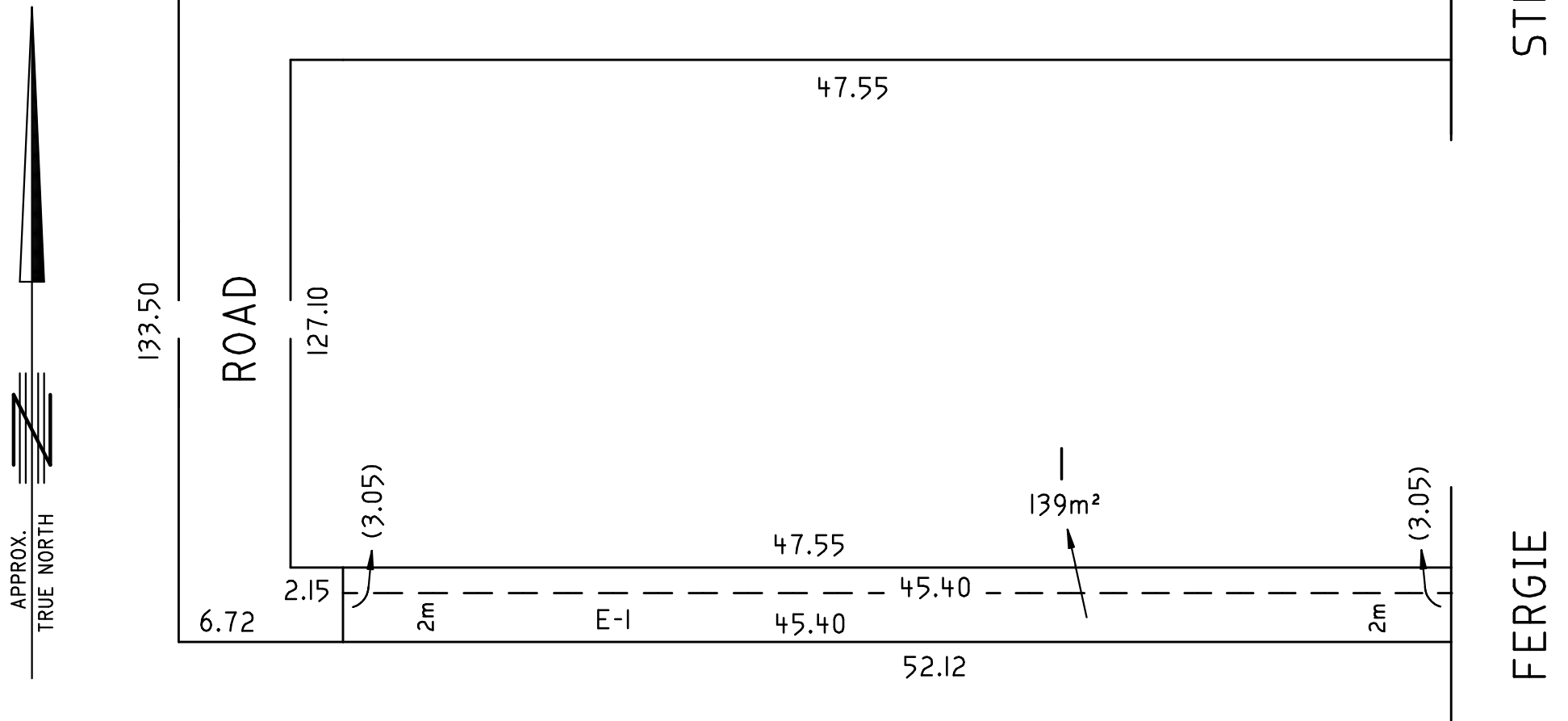

ORIGINAL SHEET SIZE: A3

CERTIFICATION BY SURVEYOR

SHEET 1 OF 1

SCALE 1:250
 2.5 0 2.5 5 7.5 10
 LENGTHS ARE IN METRES

LICENSED SURVEYOR (PRINT) . . . DEAN PAUL EDDY . . .

REF: 8539-TP VERSION: 2

SIGNATURE . . . *Dean Eddy* . . . DATE 20/04/2021

LAWLOR AND LOY VIC. PTY. LTD.
 LAND SURVEYORS • PLANNING CONSULTANTS
 EMAIL: admin@lawlorandloy.com.au PHONE: (03)9435 2422
 3/18 SHERBOURNE ROAD BRIAR HILL 3088
 (WALLAN OFFICE BY APPOINTMENT)
 www.lawlorandloy.com.au