

# TITLE PLAN

## EDITION 1

## TP

### LOCATION OF LAND

PARISH: JIKA JIKA  
AT RICHMOND

TOWNSHIP: ---

SECTION: ---

CROWN PORTION: 3 (PART)

MGA CO-ORDINATES: E 323 300 ZONE: 55  
(of approximate centre of N 5 811 490 GDA 2020  
land in plan)

DEPTH LIMITATION: DOES NOT APPLY

### NOTATIONS

THIS PLAN HAS BEEN  
PREPARED FOR LAND  
VICTORIA FOR TITLE  
DIAGRAM PURPOSES.

CHECKED BY: .....  
DATE: / /  
Assistant Registrar of Titles

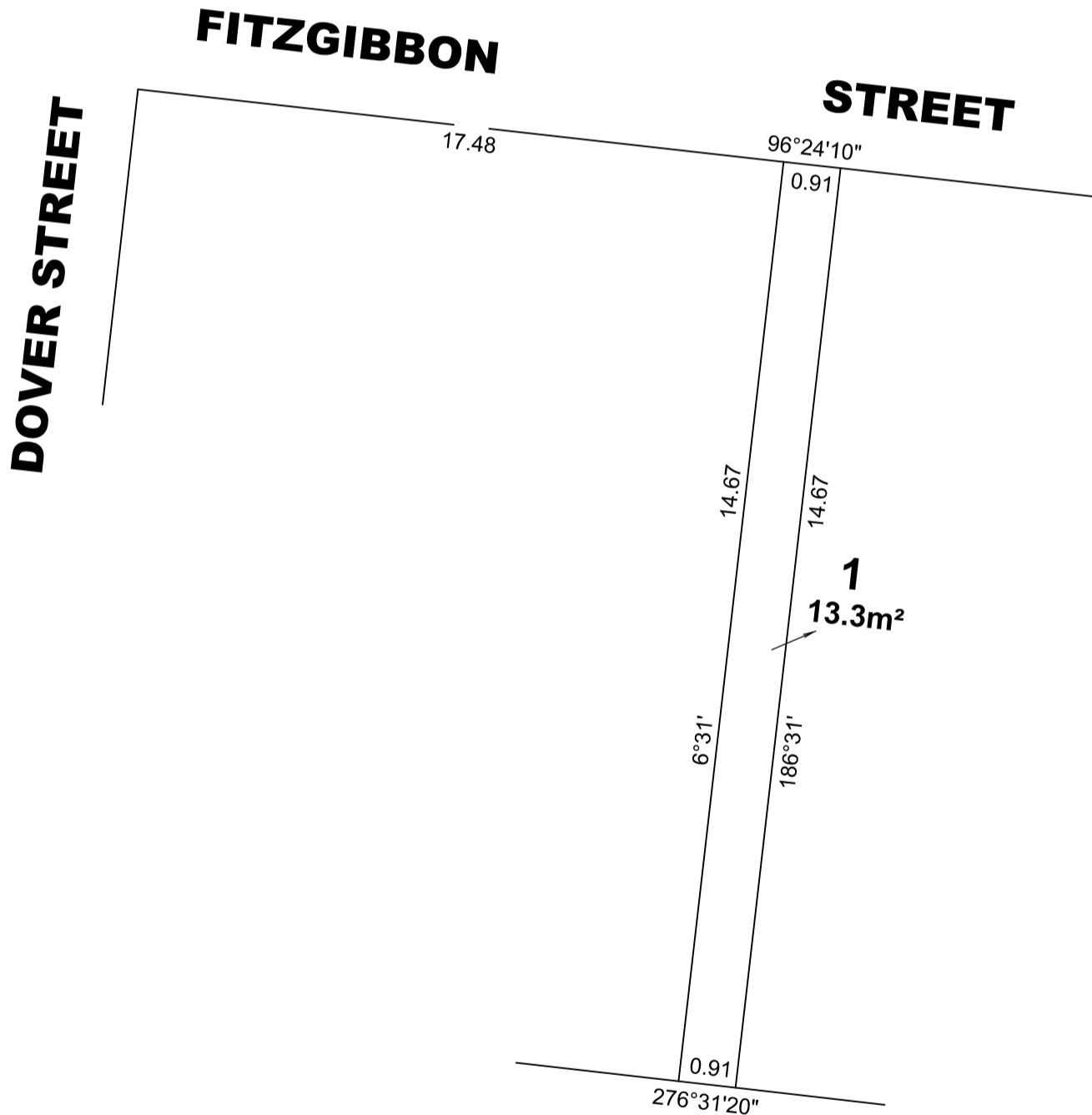

REF: 23447/TP VERSION: A DATE: 04/10/19  
23447-0-TP1-M-A.DGN

SCALE 1:100  
LENGTHS ARE IN METRES

ORIGINAL SHEET  
SIZE A3

SHEET 1

**REEDS**  
CONSULTING

Reeds Consulting Pty Ltd  
Lvl 6, 440 Elizabeth Street  
Melbourne Victoria 3000  
p (03) 8660 3000  
www.reedsconsulting.com.au  
survey@reedsconsulting.com.au

LICENSED SURVEYOR  
ALAN DAVID NORMAN

GOVERNMENT GAZETTE No.:  
DEALING/FILE No.:  
DEALING CODE: