

Find out more

Over recent years locals and traders have directly informed this project. You asked for upgraded tram stops that:

- connect to local services
- minimise impact on street parking, local traffic flows and property access
- improve journey times and reliability
- are accessible to everyone
- improve passenger amenities.

To find out more about your local tram stop you can attend a drop-in session at:

Melbourne Museum

11 Nicholson Street, Carlton
Wednesday 16 May, 6pm to 8pm

Velo Cycles

815 Nicholson Street, Carlton North
Saturday 19 May, 1pm to 3pm



Which tram stops are being upgraded?

Six tram stops on Nicholson Street are being upgraded in two 1.3km sections – see map inside to see if your local tram stop is planned for the upgrade.

Section one

Stops 11 – 15, Victoria Parade to Kerr Street

These tram stops will be upgraded from road level stops to platform stops. Construction is planned for September 2018 and will follow community consultation in May this year.

Section two

Stops 23 – 25, Brunswick Road to Victoria Street

These tram stops will be easy access stops where the road is raised (like an extended speed hump) to give passengers easy access to the tram from the kerb.

What will change on Nicholson Street?

Accessible platform and easy access tram stops are wider than old style tram stops which means they will use more of the roadway. Parking arrangements on Nicholson Street will also change around each of these six tram stops. PTV, VicRoads and local councils will continue working together to keep cars and trams moving alongside the upgraded tram stops.

See what this means for your local tram stop on the map inside.

Visit ptv.vic.gov.au/route-96-upgrade, call 1800 800 007 or email ptvprojects@ptv.vic.gov.au to find out more.

If you are deaf, or have a hearing or speech impairment, you can contact us directly or through the National Relay Service and request to call 1800 800 007.



For information in other languages:

| | | | |
|----------|-----------|---------|-----------|
| 普通話 | 9321 5454 | 廣東話 | 9321 5441 |
| Italiano | 9321 5444 | ਪੰਜਾਬੀ | 9321 5445 |
| Ελληνικά | 9321 5443 | हिन्दी | 9321 5442 |
| Việt-ngữ | 9321 5449 | සිංහල | 9321 5446 |
| عربي | 9321 5440 | Español | 9321 5447 |

If your language isn't listed visit ptv.vic.gov.au/languages or call 9321 5450.

Authorised by Transport for Victoria, 1 Spring Street, Melbourne.

96

East Brunswick –
St Kilda Beach



Route 96 project
Nicholson Street
tram stop upgrades



What is the Route 96 upgrade project?

Route 96 is being upgraded so everyone can catch the tram.

Stops at each end of Route 96 in East Brunswick and St Kilda are already fully accessible to passengers using wheelchairs, prams and other mobility aids.

Later this year, six more tram stops will be upgraded to platform and easy access style tram stops to improve safety, accessibility and journey times for all passengers.

Building new tram stops along Nicholson Street from Carlton to Brunswick helps to provide public transport that is accessible to all tram users.

Benefits include

- quicker tram travel times with a dedicated tram lane and evenly spaced stops
- more efficient use of road to improve traffic flow
- improved safety and passenger amenities at tram stops



Route 96 upgrades – six tram stops for everyone

Easy access stops

Raise the road (like an extended speed hump) to give all passengers easy access to the tram from the kerb. These stops keep traffic flowing in narrower sections of Nicholson Street and provide safe, easy access to trams. Car parking around these tram stops is reduced.

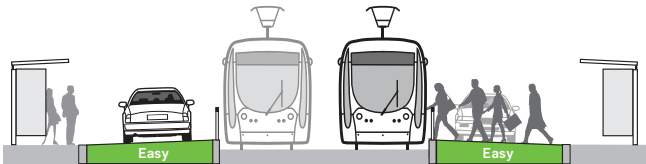

Centre island platform stops

Provide safe access to trams for people with mobility issues and separate passengers from cars and trams. Car parking is also reduced around these tram stops to support traffic flow.

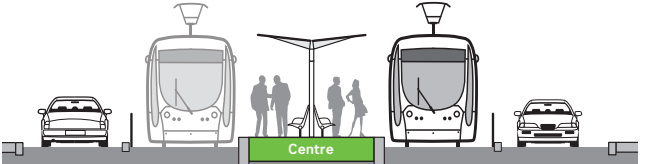

Key

Tram Route 96

200

 Bus route

Existing pedestrian crossing

New pedestrian crossing

Car parking spaces to be removed
Location of symbol on map is indicative only, and does not reflect actual location of stops being removed.

Increase in car parking spaces

Section one: Stops 11 – 15, Victoria Parade to Kerr Street (1.3km)

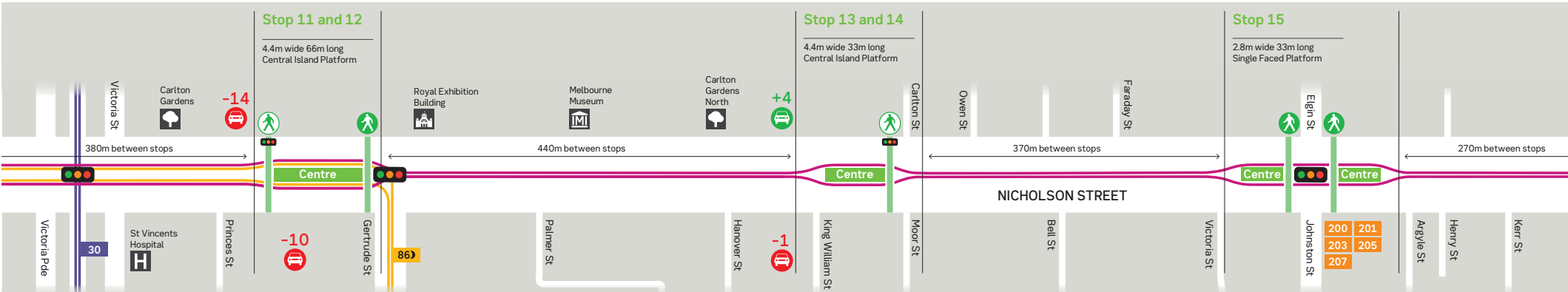

Section two: Stops 23 – 25, Brunswick Road to Victoria Street (1.3km)

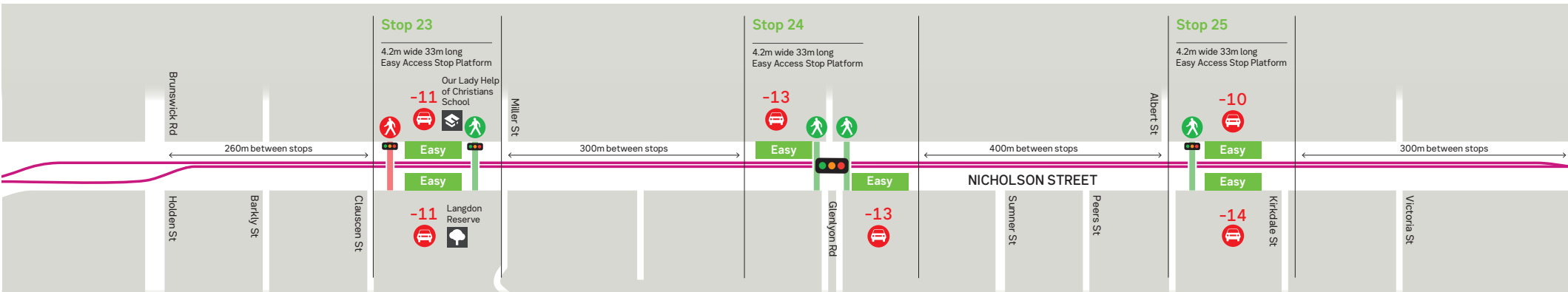

Section one: Stops 11 – 15, Victoria Parade to Kerr Street (1.3km)



Key

Tram Route 96

Tram Route 86

Bus route

Increase in car parking spaces

New pedestrian crossing

Existing tram stop to be removed

Existing pedestrian crossing to be removed

Existing pedestrian crossing

Car parking spaces to be removed

Location of symbol on map is indicative only, and does not reflect actual location of spaces being removed.

MAP NOT TO SCALE NORTH

| ARTWORK APPROVAL | | | PUBLIC TRANSPORT VICTORIA | Date: 1st Feb 2018 | <p>All care is taken in producing artwork and it is checked thoroughly to the best of our ability. But it is the sole responsibility of the Project Owner to seek approval, proofread and check their work during all stages of development and notify the PTV design team of any corrections, alterations or proposed amendments.</p> <p>All artwork must be signed off and approved before going to print.</p> |
|--------------------------------------------------------------------------------|------------------------------------------------|-------------------------------------------|---------------------------|--------------------|------------------------------------------------------------------------------------------------------------------------------------------------------------------------------------------------------------------------------------------------------------------------------------------------------------------------------------------------------------------------------------------------------------------|
| Project Name: | Job Number: | Item: | Specs: | | |
| Nicholson Street Upgrade | PTVH2803 | Tramline map 850x250mm | | | |
| Status: | | | | | |
| <input type="checkbox"/> Approved | <input type="checkbox"/> Approved With Changes | <input type="checkbox"/> Changes Required | | | |
| Finished Artist | | Senior Designer/Creative Lead | | | |
| Name: | | Name: | | | |
| Daisy Cai | | | | | |
| Project Owner | | Signature: | | | |
| Name: | | | | | |
| General Manager/Brand And Partnerships Manager, Brand And Customer Information | | | | | |
| Name (Please Print): | | Signature: | | | |

Section two: Stops 23 – 25, Brunswick Road to Victoria Street (1.3km)

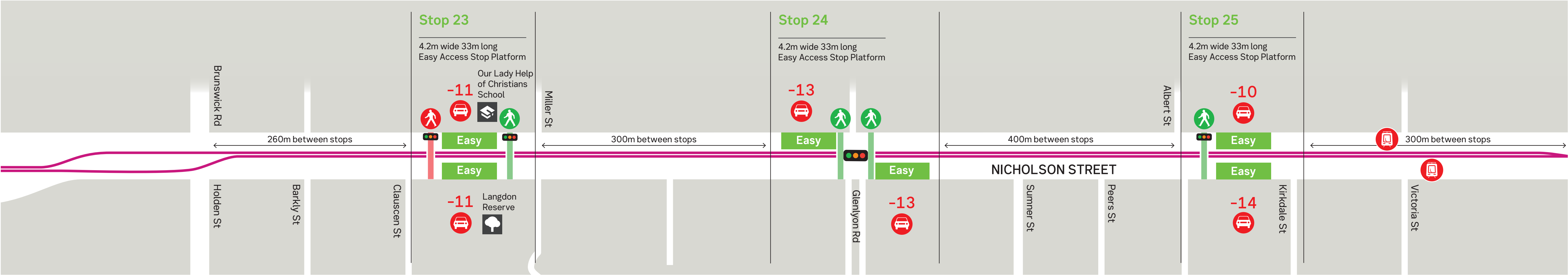



Key

 Tram Route 96

 Existing tram stop to be removed

 Existing pedestrian crossing

 Existing pedestrian crossing to be removed

 Car parking spaces to be removed
Location of symbol on map is indicative only, and does not reflect actual location of spaces being removed.



Route 96 project Nicholson Street tram stop upgrades

Stop 11 & 12

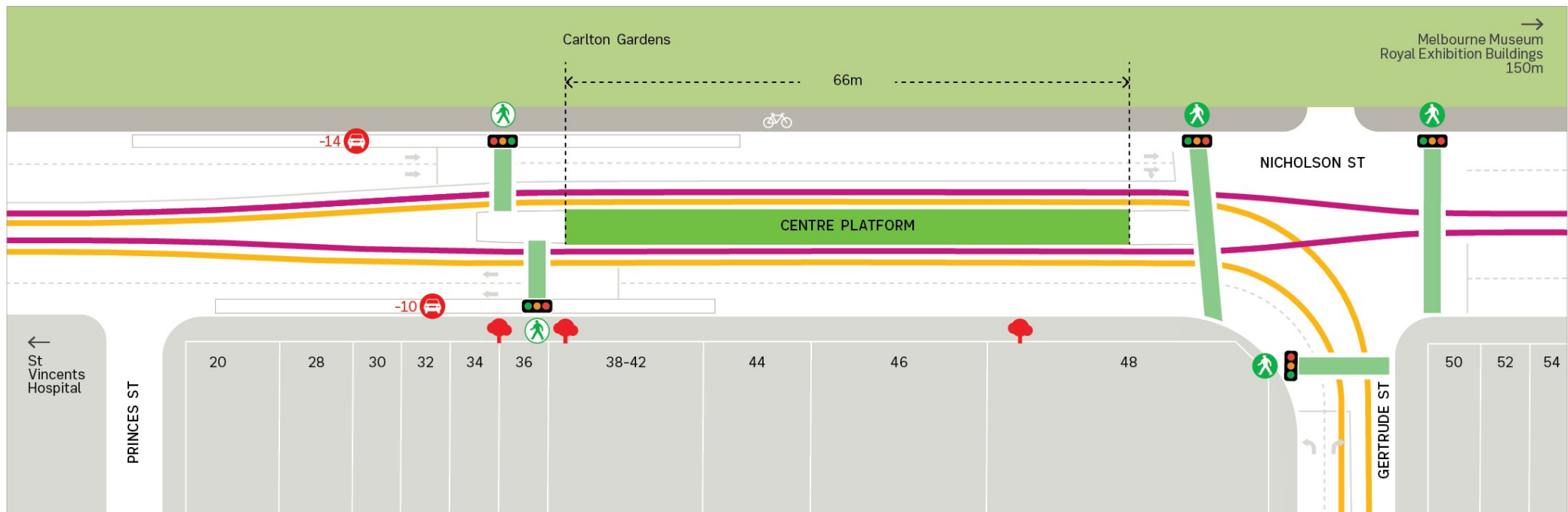
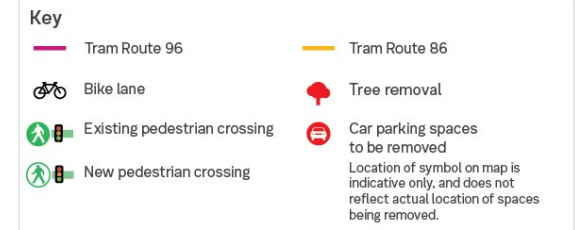

Total number of car spaces gained/lost: -24

← 380m to next stop 440m to next stop →





Route 96 project

Nicholson Street tram stop upgrades

Stop 13 & 14



Key

- Tram Route 96
 - Bike lane
 - New pedestrian crossing
 - 300mm road widening
 - Tree removal
 - Increase in car parking space
 - Car parking spaces to be removed
- Location of symbol on map is indicative only, and does not reflect actual location of spaces being removed.

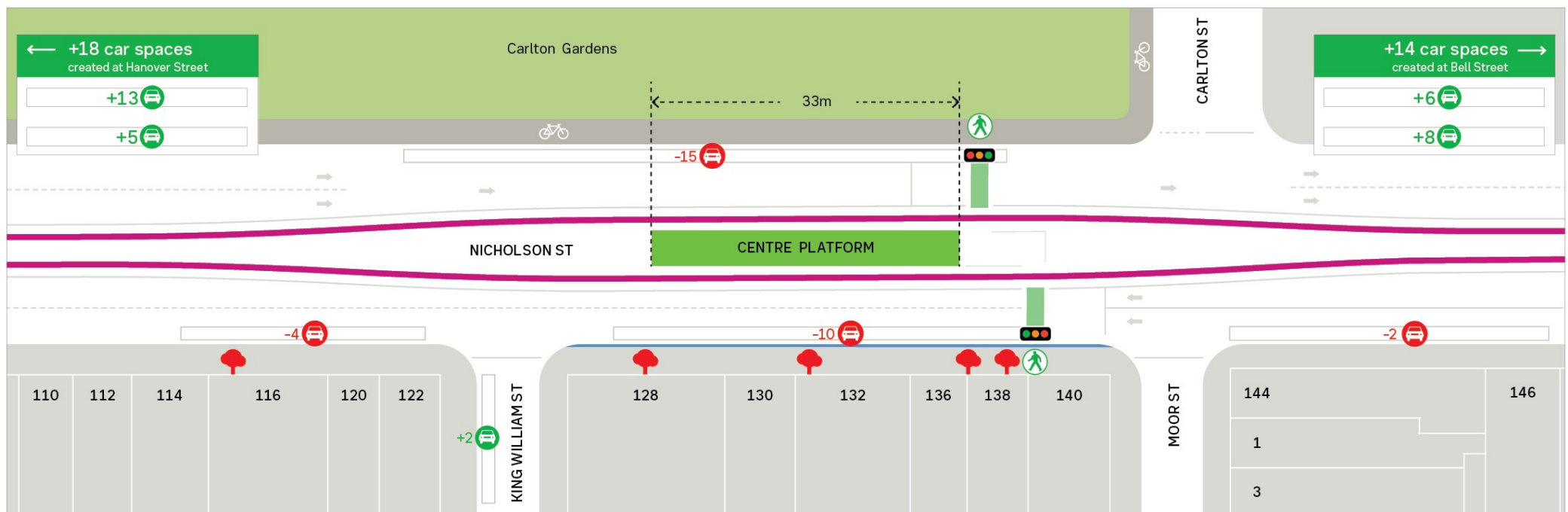

Total number of car spaces gained/lost: +34 (+13 car spaces, +5 car spaces, +2 car spaces) -31 (-15 car spaces, -2 car spaces) Net gain/loss: +3 (+2 car spaces)

← 440m to next stop (left) 370m to next stop (right) →



Route 96 project Nicholson Street tram stop upgrades

Stop 15

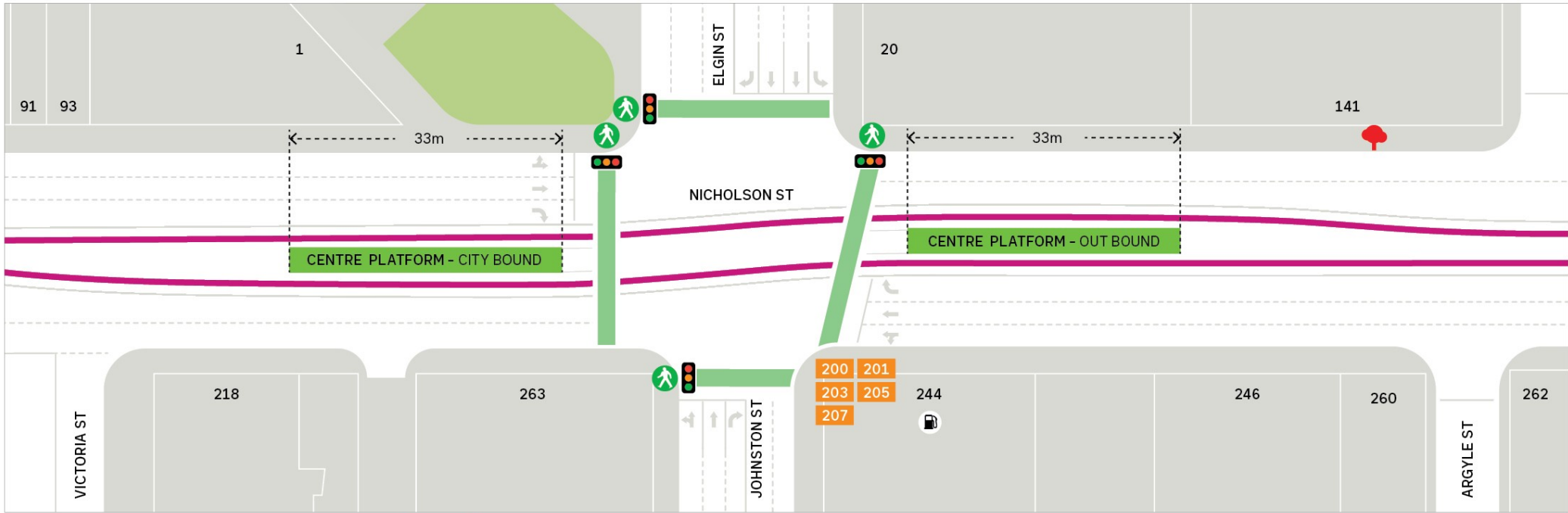
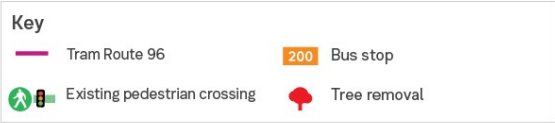

Total number of car spaces gained/lost: +0 -0

← 370m to next stop 270m to next stop →



Route 96 project

Nicholson Street tram stop upgrades

Stop 23

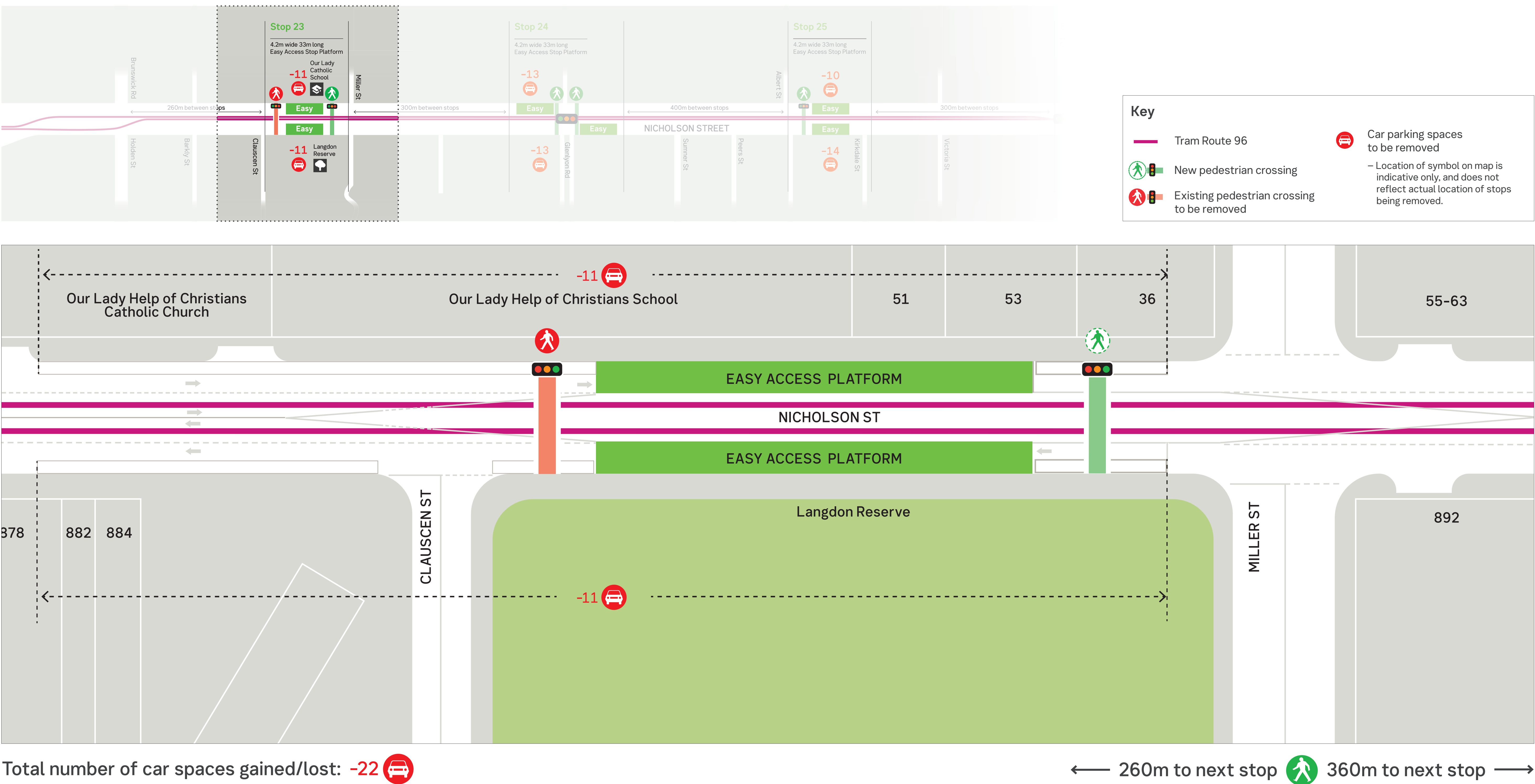



Route 96 project

Nicholson Street tram stop upgrades

Stop 24

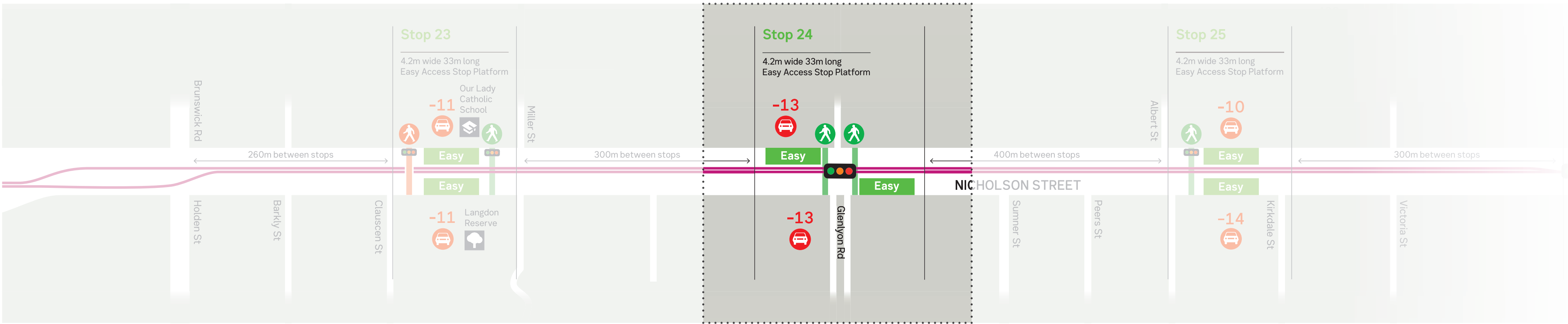

Key

- Tram Route 96
- Existing pedestrian crossing
- Car parking spaces to be removed

– Location of symbol on map is indicative only, and does not reflect actual location of stops being removed.

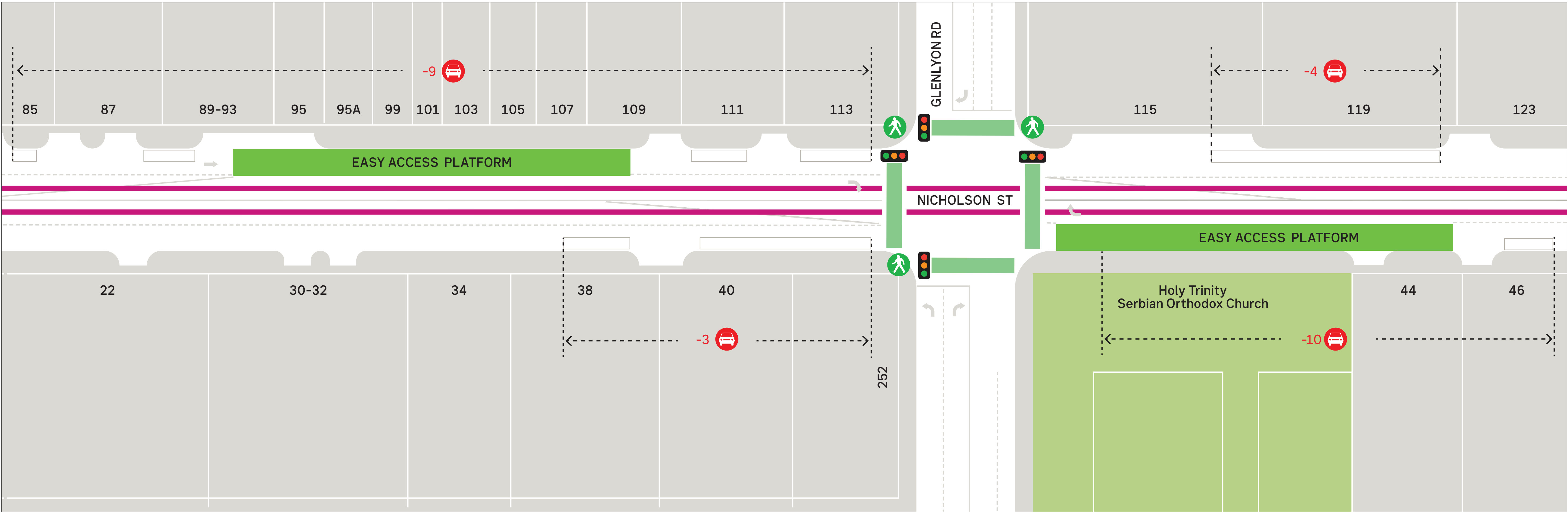

Total number of car spaces gained/lost: -26

← 360m to next stop → 360m to next stop →



Route 96 project

Nicholson Street tram stop upgrades

Stop 25

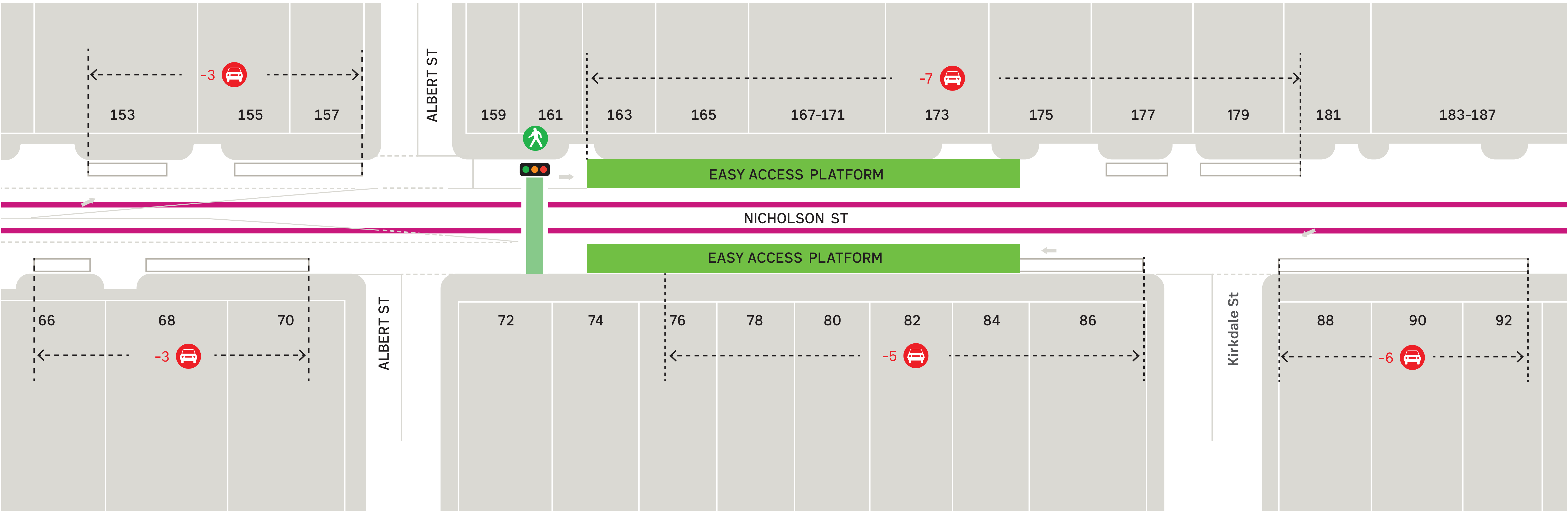
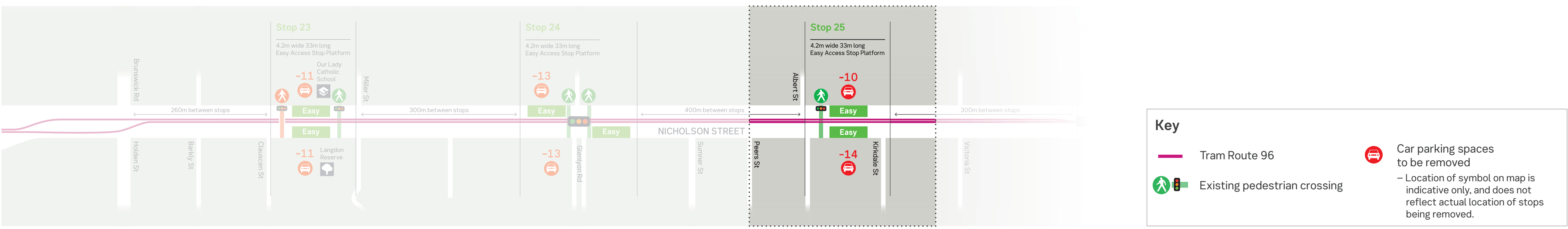

Total number of car spaces gained/lost: -24

← 400m to next stop 300m to next stop →