



Renaming of part of Latrobe Avenue Alphington

Council is proposing to rename the northern section of Latrobe Avenue Alphington, comprising the section of road of approximately 275m in length immediately south of Heidelberg Road (see map overleaf).

The former paper mill at the corner of Chandler Highway and Heidelberg Road in Alphington is currently being redeveloped into a residential subdivision. As part of this process, a new street network is being created to service the subdivision. The process for naming these streets is almost complete, with the developer having had responsibility for proposing the street names, and Council approval now having been granted. The new street names will be submitted via SPEAR.

The outstanding issue is that there is a section of an existing street which Council is proposing to rename, as is shown on the attached plan. It is planned that the new Mills Boulevard will be an L shaped street connecting Heidelberg Road and Chandler Highway, and Latrobe Avenue will be a smaller street running southward from the bend in Mills Boulevard. Latrobe Avenue will be narrower and traffic will be required to give way at the intersection with Mills Boulevard.

If you have a view on this proposal, or another suggestion for a name, please let us know.

Submissions can be sent:

By email to rhys.thomas@yarracity.vic.gov.au

By mail to Senior Governance Advisor
City of Yarra
PO Box 168
RICHMOND VIC 3121

In order to be considered, your submission and any supporting information will need to reach us by Friday 22 June 2018.

If you have any questions on this proposal, please contact Council's Senior Governance Advisor, Rhys Thomas at rhys.thomas@yarracity.vic.gov.au or on 9205 5302.

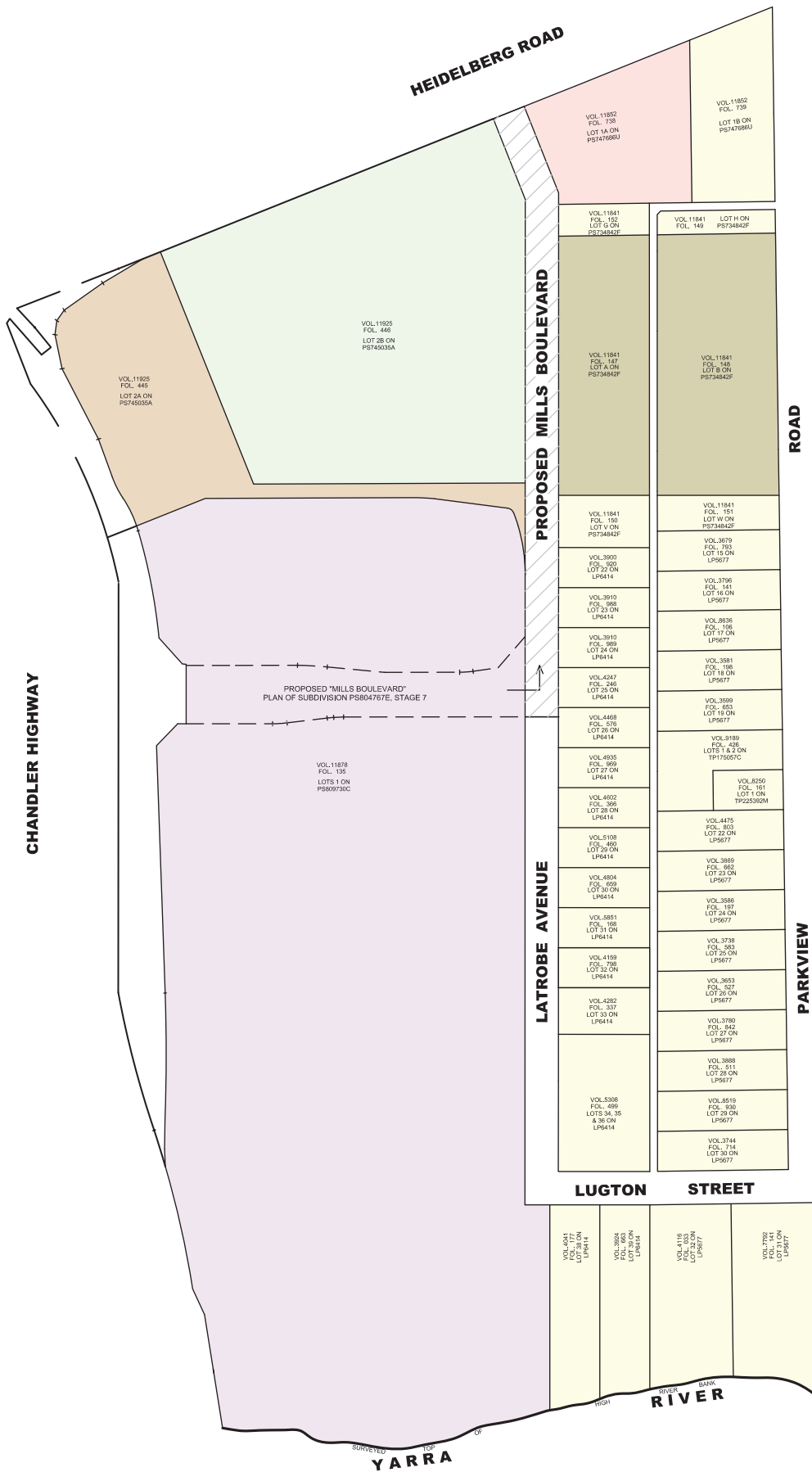

- ABUTTING LAND OWNERS**
- 1A. REGISTERED PROPRIETOR: ALPHINGTON DEVELOPMENTS P/L
 - 1B. REGISTERED PROPRIETOR: ALPHINGTON DEVELOPMENTS P/L
 - 2. REGISTERED PROPRIETOR: U-HOME OCEANIA P/L
 - 3. REGISTERED PROPRIETOR: CP ALPHINGTON NOMINEES P/L
 - 4. REGISTERED PROPRIETOR: ALPHA APM NO 2 P/L
 - 5. REGISTERED PROPRIETOR: J & G KNOWLES AND ASSOCIATES P/L
 - PART OF LATROBE AVENUE TO BE RENAMED MILLS BOULEVARD

ROAD RENAMING - ABUTTING OWNERS
Yarra Bend - Latrobe Avenue, Alphington



LEVEL 6
440 ELIZABETH STREET
MELBOURNE VIC 3000
(03) 8660 3000
SURVEY@REEDSCONSULTING.COM.AU
WWW.REEDSCONSULTING.COM.AU

