

Appendix A

Copies of Title

Copyright State of Victoria. This publication is copyright. No part may be reproduced by any process except in accordance with the provisions of the Copyright Act 1968 (Cth) and for the purposes of Section 32 of the Sale of Land Act 1962 (Vic) or pursuant to a written agreement. The information is only valid at the time and in the form obtained from the LANDATA REGD TM System. None of the State of Victoria, LANDATA REGD TM System, Victorian Land Registry Services Pty. Ltd. ABN 86 627 986 396 as trustee for the Victorian Land Registry Services Trust ABN 83 206 746 897 accept responsibility for any subsequent release, publication or reproduction of the information.

REGISTER SEARCH STATEMENT (Title Search) Transfer of Land Act 1958

VOLUME 12182 FOLIO 650

Security no : 124085672487K

Produced 23/09/2020 12:32 PM

LAND DESCRIPTION

Lots 1,2 and 4 on Plan of Subdivision 030569.
PARENT TITLE Volume 08697 Folio 817
Created by instrument AS880878L 10/01/2020

REGISTERED PROPRIETOR

Estate Fee Simple
Sole Proprietor

ISLINGTON99 PTY LTD of SUITE 1203 9 YARRA STREET SOUTH YARRA VIC 3141
AS955303B 03/02/2020

ENCUMBRANCES, CAVEATS AND NOTICES

MORTGAGE AS955304Y 03/02/2020
WESTPAC BANKING CORPORATION

Any encumbrances created by Section 98 Transfer of Land Act 1958 or Section 24 Subdivision Act 1988 and any other encumbrances shown or entered on the plan or imaged folio set out under DIAGRAM LOCATION below.

DIAGRAM LOCATION

SEE LP030569 FOR FURTHER DETAILS AND BOUNDARIES

ACTIVITY IN THE LAST 125 DAYS

NIL

-----END OF REGISTER SEARCH STATEMENT-----

Additional information: (not part of the Register Search Statement)

ADMINISTRATIVE NOTICES

NIL

eCT Control 19065N THOMSON GEER
Effective from 03/02/2020

DOCUMENT END

Delivered from the LANDATA® System by InfoTrack Pty Ltd.

The information supplied by InfoTrack (BHL Insight) has been obtained from InfoTrack Pty Limited by agreement between them. The information supplied has been obtained by InfoTrack Pty Limited who is licensed by the State of Victoria to provide this information via LANDATA® System.

© State of Victoria. This publication is copyright. No part may be reproduced by any process except in accordance with the provisions of the Copyright Act 1968 (Cth) and for the purposes of Section 32 of the Sale of Land Act 1962 or pursuant to a written agreement. The information is only valid at the time and in the form obtained from the LANDATA® System. None of the State of Victoria, LANDATA®, Victorian Land Registry Services Pty. Ltd. ABN 86 627 986 396 as trustee for the Victorian Land Registry Services Trust ABN 83 206 746 897 accept responsibility for any subsequent release, publication or reproduction of the information.

3 LP 30569



LP 30569
EDITION 2

PLAN OF SUBDIVISION
OF PART OF CROWN PORTION 55
PARISH OF JIKA JIKA
COUNTY OF BOURKE

SCALE OF FEET

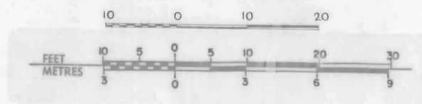

FEET	METRES	FEET	METRES
0.12	0.037	35.00	10.058
0.25	0.076	35.12	10.095
0.33	0.101	35.25	10.135
0.38	0.116	35.35	10.165
0.75	0.229	35.60	10.241
5.83	1.777	57.38	17.489
6.04	1.841	61.33	18.693
6.15	1.875	65.08	19.227
6.21	1.895	65.50	19.364
6.29	1.917	80.21	24.448
7.36	2.249	86.08	26.237
7.54	2.298	102.38	31.205
7.58	2.310	307.00	93.974
7.75	2.362		
8.73	2.661		
8.79	2.679		
9.00	2.743		
14.50	4.420		
14.62	4.456		
14.67	4.471		
14.92	4.548		
15.17	4.624		
17.54	5.346		
18.08	5.511		
24.71	7.532		
24.96	7.608		
28.32	8.615		
28.96	8.827		

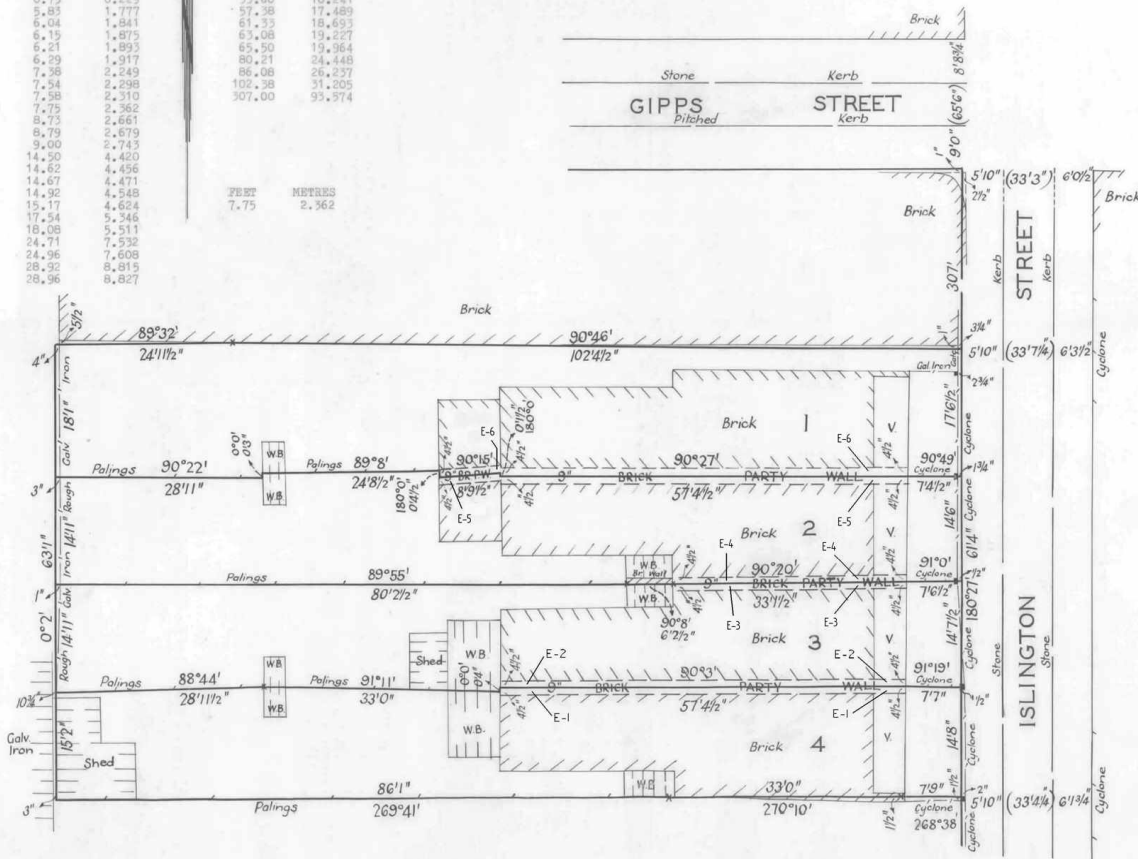

COLOUR CODE
E-3, E-4 & E-1= BLUE
E-6, E-4 & E-2= YELLOW

LP 30569

30569
30569

REF. 11170

LX 11
AC B

FOR APPROPRIATIONS ETC.
SEE BACK HEREOF

LP 30569

Conceder dda v

SUBDIVISIONAL
 CERTIFICATE OF TITLE V. 6350 F. 924

**FOR TITLE REFERENCES TO LOTS
 SEE PARCELS INDEX**

LODGED BY C.T. Erland

DEALING No. 5555504 DATE 3 / 5 / 54

DECLARED BY R.D. Steele

ON 21 / 7 / 55

COUNCIL Stat. Dec. in Liew of ED's Report.

DATE OF CONSENT / /

PLAN MAY BE LODGED 25 / 7 / 55

PLAN APPROVED. DATE / / TIME a.m.
 p.m.

The land coloured yellow and blue
 is appropriated or set apart for
 easements of party wall.

NOTATIONS

AS TO THE LAND MARKED E-1 AND E-4 RESPECTIVELY:
 TOGETHER WITH A RIGHT TO USE THE LAND MARKED E-2 AND E-3
 RESPECTIVELY ON THE MAP FOR PARTY WALL PURPOSES

AS TO LOT 3:
 TOGETHER WITH A RIGHT TO USE THE LAND MARKED E-1 AND E-4
 ON THE MAP FOR PARTY WALL PURPOSES

ENCUMBRANCES

AS TO THE LAND MARKED E-1 AND E-4:
 THE PARTY WALL EASEMENTS CREATED BY TRANSFER 2680324

AS TO THE LAND MARKED E-2 AND E-3
 ANY EASEMENTS AFFECTING THE SAME

THIS IS THE BACK OF LP 30569

LIST OF MODIFICATIONS				
LAND	MODIFICATION	DEALING No.	A.R.T	EDN. No.
	APPURTENANT EASEMENTS	<u> </u>		2
	CREATION OF EASEMENTS	<u> </u>		2

PHOTOGRAPHED AT CENTRAL PLAN OFFICE

SIZE DATE

COLOURED dh CHECKED JL Chambers

POSTED dh CHECKED JL Chambers

11437/72

Copyright State of Victoria. This publication is copyright. No part may be reproduced by any process except in accordance with the provisions of the Copyright Act 1968 (Cth) and for the purposes of Section 32 of the Sale of Land Act 1962 (Vic) or pursuant to a written agreement. The information is only valid at the time and in the form obtained from the LANDATA REGD TM System. None of the State of Victoria, LANDATA REGD TM System, Victorian Land Registry Services Pty. Ltd. ABN 86 627 986 396 as trustee for the Victorian Land Registry Services Trust ABN 83 206 746 897 accept responsibility for any subsequent release, publication or reproduction of the information.

REGISTER SEARCH STATEMENT (Title Search) Transfer of Land Act 1958

VOLUME 12182 FOLIO 647

Security no : 124085672473A

Produced 23/09/2020 12:32 PM

LAND DESCRIPTION

Lot 1 on Title Plan 692694K.
PARENT TITLE Volume 04869 Folio 755
Created by instrument AS880878L 10/01/2020

REGISTERED PROPRIETOR

Estate Fee Simple
Sole Proprietor
ISLINGTON99 PTY LTD of SUITE 1203 9 YARRA STREET SOUTH YARRA VIC 3141
AS955303B 03/02/2020

ENCUMBRANCES, CAVEATS AND NOTICES

MORTGAGE AS955304Y 03/02/2020
WESTPAC BANKING CORPORATION

Any encumbrances created by Section 98 Transfer of Land Act 1958 or Section 24 Subdivision Act 1988 and any other encumbrances shown or entered on the plan set out under DIAGRAM LOCATION below.

DIAGRAM LOCATION

SEE TP692694K FOR FURTHER DETAILS AND BOUNDARIES

ACTIVITY IN THE LAST 125 DAYS

NIL

-----END OF REGISTER SEARCH STATEMENT-----

Additional information: (not part of the Register Search Statement)

Street Address: 99-117 ISLINGTON STREET COLLINGWOOD VIC 3066

ADMINISTRATIVE NOTICES

NIL

eCT Control 19065N THOMSON GEER
Effective from 03/02/2020

DOCUMENT END

Delivered from the LANDATA® System by InfoTrack Pty Ltd.

The information supplied by InfoTrack (BHL Insight) has been obtained from InfoTrack Pty Limited by agreement between them. The information supplied has been obtained by InfoTrack Pty Limited who is licensed by the State of Victoria to provide this information via LANDATA® System.

TITLE PLAN	EDITION 1	TP 692694K						
Location of Land Parish: AT COLLINGWOOD PARISH OF JIKA JIKA Township: Section: Crown Allotment: Crown Portion: 55(PT) Last Plan Reference: Derived From: VOL 4869 FOL 755 Depth Limitation: NIL		Notations ANY REFERENCE TO MAP IN THE TEXT MEANS THE DIAGRAM SHOWN ON THIS TITLE PLAN						
Description of Land / Easement Information		THIS PLAN HAS BEEN PREPARED FOR THE LAND REGISTRY, LAND VICTORIA, FOR TITLE DIAGRAM PURPOSES AS PART OF THE LAND TITLES AUTOMATION PROJECT COMPILED: 21/11/2000 VERIFIED: SO'C						
<p style="text-align: center;">Kerb CIPPS STREET</p> <p style="text-align: center;">ISLINGTON STREET</p> <p style="text-align: center;">1</p> <p style="text-align: center;">101'9" to kerb</p> <p style="text-align: center;">91"</p> <p style="text-align: center;">125'10 1/2"</p> <p style="text-align: center;">589°52'W</p> <p style="text-align: center;">1371"</p> <p style="text-align: center;">50°50'N</p> <p style="text-align: center;">57'3 1/2"</p> <p style="text-align: center;">589°23'E</p> <p style="text-align: center;">67'2 1/2"</p> <p style="text-align: center;">N89°43'E</p> <p style="text-align: center;">39'</p> <p style="text-align: center;">15'</p> <p style="text-align: center;">N0°53'E N2°17'E N0°25'W</p> <p style="text-align: center;">38'10"</p> <p style="text-align: center;">39'</p> <p style="text-align: center;">50'7 1/2"</p> <p style="text-align: center;">N1°04'E</p>								
<table border="1" style="width: 100%; border-collapse: collapse;"> <tr> <th colspan="2" style="text-align: center;">TABLE OF PARCEL IDENTIFIERS</th> </tr> <tr> <td colspan="2" style="font-size: small;">WARNING: Where multiple parcels are referred to or shown on this Title Plan this does not imply separately disposable parcels under Section 8A of the Sale of Land Act 1962</td> </tr> <tr> <td colspan="2" style="font-size: small;">PARCEL 1 = CP 55 (PT)</td> </tr> </table>			TABLE OF PARCEL IDENTIFIERS		WARNING: Where multiple parcels are referred to or shown on this Title Plan this does not imply separately disposable parcels under Section 8A of the Sale of Land Act 1962		PARCEL 1 = CP 55 (PT)	
TABLE OF PARCEL IDENTIFIERS								
WARNING: Where multiple parcels are referred to or shown on this Title Plan this does not imply separately disposable parcels under Section 8A of the Sale of Land Act 1962								
PARCEL 1 = CP 55 (PT)								
LENGTHS ARE IN FEET & INCHES	Metres = 0.3048 x Feet Metres = 0.201168 x Links	Sheet 1 of 1 sheets						

Copyright State of Victoria. This publication is copyright. No part may be reproduced by any process except in accordance with the provisions of the Copyright Act 1968 (Cth) and for the purposes of Section 32 of the Sale of Land Act 1962 (Vic) or pursuant to a written agreement. The information is only valid at the time and in the form obtained from the LANDATA REGD TM System. None of the State of Victoria, LANDATA REGD TM System, Victorian Land Registry Services Pty. Ltd. ABN 86 627 986 396 as trustee for the Victorian Land Registry Services Trust ABN 83 206 746 897 accept responsibility for any subsequent release, publication or reproduction of the information.

REGISTER SEARCH STATEMENT (Title Search) Transfer of Land Act 1958

VOLUME 12182 FOLIO 650

Security no : 124085672487K

Produced 23/09/2020 12:32 PM

LAND DESCRIPTION

Lots 1,2 and 4 on Plan of Subdivision 030569.
PARENT TITLE Volume 08697 Folio 817
Created by instrument AS880878L 10/01/2020

REGISTERED PROPRIETOR

Estate Fee Simple
Sole Proprietor

ISLINGTON99 PTY LTD of SUITE 1203 9 YARRA STREET SOUTH YARRA VIC 3141
AS955303B 03/02/2020

ENCUMBRANCES, CAVEATS AND NOTICES

MORTGAGE AS955304Y 03/02/2020
WESTPAC BANKING CORPORATION

Any encumbrances created by Section 98 Transfer of Land Act 1958 or Section 24 Subdivision Act 1988 and any other encumbrances shown or entered on the plan or imaged folio set out under DIAGRAM LOCATION below.

DIAGRAM LOCATION

SEE LP030569 FOR FURTHER DETAILS AND BOUNDARIES

ACTIVITY IN THE LAST 125 DAYS

NIL

-----END OF REGISTER SEARCH STATEMENT-----

Additional information: (not part of the Register Search Statement)

ADMINISTRATIVE NOTICES

NIL

eCT Control 19065N THOMSON GEER
Effective from 03/02/2020

DOCUMENT END

Delivered from the LANDATA® System by InfoTrack Pty Ltd.

The information supplied by InfoTrack (BHL Insight) has been obtained from InfoTrack Pty Limited by agreement between them. The information supplied has been obtained by InfoTrack Pty Limited who is licensed by the State of Victoria to provide this information via LANDATA® System.

Copyright State of Victoria. This publication is copyright. No part may be reproduced by any process except in accordance with the provisions of the Copyright Act 1968 (Cth) and for the purposes of Section 32 of the Sale of Land Act 1962 (Vic) or pursuant to a written agreement. The information is only valid at the time and in the form obtained from the LANDATA REGD TM System. None of the State of Victoria, LANDATA REGD TM System, Victorian Land Registry Services Pty. Ltd. ABN 86 627 986 396 as trustee for the Victorian Land Registry Services Trust ABN 83 206 746 897 accept responsibility for any subsequent release, publication or reproduction of the information.

REGISTER SEARCH STATEMENT (Title Search) Transfer of Land Act 1958

VOLUME 12182 FOLIO 648

Security no : 124085672475X

Produced 23/09/2020 12:32 PM

LAND DESCRIPTION

Lot 1 on Title Plan 853959E.
PARENT TITLE Volume 05221 Folio 074
Created by instrument AS880878L 10/01/2020

REGISTERED PROPRIETOR

Estate Fee Simple
Sole Proprietor
ISLINGTON99 PTY LTD of SUITE 1203 9 YARRA STREET SOUTH YARRA VIC 3141
AS955303B 03/02/2020

ENCUMBRANCES, CAVEATS AND NOTICES

MORTGAGE AS955304Y 03/02/2020
WESTPAC BANKING CORPORATION

Any encumbrances created by Section 98 Transfer of Land Act 1958 or Section 24 Subdivision Act 1988 and any other encumbrances shown or entered on the plan set out under DIAGRAM LOCATION below.

DIAGRAM LOCATION

SEE TP853959E FOR FURTHER DETAILS AND BOUNDARIES

ACTIVITY IN THE LAST 125 DAYS

NIL

-----END OF REGISTER SEARCH STATEMENT-----

Additional information: (not part of the Register Search Statement)

Street Address: 99-117 ISLINGTON STREET COLLINGWOOD VIC 3066

ADMINISTRATIVE NOTICES

NIL

eCT Control 19065N THOMSON GEER
Effective from 03/02/2020

DOCUMENT END

Delivered from the LANDATA® System by InfoTrack Pty Ltd.

The information supplied by InfoTrack (BHL Insight) has been obtained from InfoTrack Pty Limited by agreement between them. The information supplied has been obtained by InfoTrack Pty Limited who is licensed by the State of Victoria to provide this information via LANDATA® System.

© State of Victoria. This publication is copyright. No part may be reproduced by any process except in accordance with the provisions of the Copyright Act 1968 (Cth) and for the purposes of Section 32 of the Sale of Land Act 1962 or pursuant to a written agreement. The information is only valid at the time and in the form obtained from the LANDATA® System. None of the State of Victoria, LANDATA®, Victorian Land Registry Services Pty. Ltd. ABN 86 627 986 396 as trustee for the Victorian Land Registry Services Trust ABN 83 206 746 897 accept responsibility for any subsequent release, publication or reproduction of the information.

TITLE PLAN	EDITION 1	TP 853959E						
Location of Land Parish : JIKA JIKA Township : - Crown Allotment : - Crown Portion : 55(PT) Section : - Last Plan Reference : Derived From : VOL. 5221 FOL. 074 Depth Limitation : NIL	Notations ANY REFERENCE TO MAP IN THE TEXT MEANS THE DIAGRAM SHOWN ON THIS TITLE PLAN							
Description of Land/ Easement Information		THIS PLAN HAS BEEN PREPARED BY LAND REGISTRY, LAND VICTORIA FOR TITLE DIAGRAM PURPOSES COMPILED: Date 8/06/06 VERIFIED: A. DALLAS Assistant Registrar of Titles						
<p style="text-align: center;"><i>GIPPS STREET</i></p> <p style="text-align: center;"><i>ISLINGTON STREET</i></p> <p style="text-align: center;">RECTIFIED BY DIRECTION IN APPL. NO. 53916 <i>[Signature]</i> 22-12-1970</p> <p style="text-align: center;">Excised</p> <p style="text-align: center;">N 1° 11' E 32' 7 1/2" 25' 3" S 89° 44' W</p> <p style="text-align: center;">N 1° 40' E 32' 1/2" 102' N 89° 2' W</p> <p style="text-align: center;">N 89° 28' W 05" 77' 3" 50' 34" W</p> <p style="text-align: center;">N 89° 52' E 125' 10 1/2" 220' 9"</p>								
<table border="1" style="width: 100%; border-collapse: collapse;"> <tr> <th colspan="2" style="text-align: center;">TABLE OF PARCEL IDENTIFIERS</th> </tr> <tr> <td colspan="2" style="text-align: center; font-size: small;">WARNING: Where multiple parcels are referred to or shown on the Title Plan this does Not imply separately disposable parcels under Section 8A of the Sale of Land Act 1962</td> </tr> <tr> <td colspan="2" style="text-align: center;">LOT 1 = CP55 (PT)</td> </tr> </table>			TABLE OF PARCEL IDENTIFIERS		WARNING: Where multiple parcels are referred to or shown on the Title Plan this does Not imply separately disposable parcels under Section 8A of the Sale of Land Act 1962		LOT 1 = CP55 (PT)	
TABLE OF PARCEL IDENTIFIERS								
WARNING: Where multiple parcels are referred to or shown on the Title Plan this does Not imply separately disposable parcels under Section 8A of the Sale of Land Act 1962								
LOT 1 = CP55 (PT)								
LENGTHS ARE IN FEET AND INCHES	Metres = 0.3048 x Feet Metres = 0.201168 x Links	Sheet 1 of 1 Sheets						

Copyright State of Victoria. This publication is copyright. No part may be reproduced by any process except in accordance with the provisions of the Copyright Act 1968 (Cth) and for the purposes of Section 32 of the Sale of Land Act 1962 (Vic) or pursuant to a written agreement. The information is only valid at the time and in the form obtained from the LANDATA REGD TM System. None of the State of Victoria, LANDATA REGD TM System, Victorian Land Registry Services Pty. Ltd. ABN 86 627 986 396 as trustee for the Victorian Land Registry Services Trust ABN 83 206 746 897 accept responsibility for any subsequent release, publication or reproduction of the information.

REGISTER SEARCH STATEMENT (Title Search) Transfer of Land Act 1958

VOLUME 12182 FOLIO 649

Security no : 124085672480S

Produced 23/09/2020 12:32 PM

LAND DESCRIPTION

Lot 3 on Plan of Subdivision 030569.
PARENT TITLE Volume 08088 Folio 017
Created by instrument AS880878L 10/01/2020

REGISTERED PROPRIETOR

Estate Fee Simple
Sole Proprietor

ISLINGTON99 PTY LTD of SUITE 1203 9 YARRA STREET SOUTH YARRA VIC 3141
AS955303B 03/02/2020

ENCUMBRANCES, CAVEATS AND NOTICES

MORTGAGE AS955304Y 03/02/2020
WESTPAC BANKING CORPORATION

Any encumbrances created by Section 98 Transfer of Land Act 1958 or Section 24 Subdivision Act 1988 and any other encumbrances shown or entered on the plan or imaged folio set out under DIAGRAM LOCATION below.

DIAGRAM LOCATION

SEE LP030569 FOR FURTHER DETAILS AND BOUNDARIES

ACTIVITY IN THE LAST 125 DAYS

NIL

-----END OF REGISTER SEARCH STATEMENT-----

Additional information: (not part of the Register Search Statement)

Street Address: 99-117 ISLINGTON STREET COLLINGWOOD VIC 3066

ADMINISTRATIVE NOTICES

NIL

eCT Control 19065N THOMSON GEER
Effective from 03/02/2020

DOCUMENT END

Delivered from the LANDATA® System by InfoTrack Pty Ltd.

The information supplied by InfoTrack (BHL Insight) has been obtained from InfoTrack Pty Limited by agreement between them. The information supplied has been obtained by InfoTrack Pty Limited who is licensed by the State of Victoria to provide this information via LANDATA® System.

© State of Victoria. This publication is copyright. No part may be reproduced by any process except in accordance with the provisions of the Copyright Act 1968 (Cth) and for the purposes of Section 32 of the Sale of Land Act 1962 or pursuant to a written agreement. The information is only valid at the time and in the form obtained from the LANDATA® System. None of the State of Victoria, LANDATA®, Victorian Land Registry Services Pty. Ltd. ABN 86 627 986 396 as trustee for the Victorian Land Registry Services Trust ABN 83 206 746 897 accept responsibility for any subsequent release, publication or reproduction of the information.

3 LP 30569



LP 30569
EDITION 2

PLAN OF SUBDIVISION
OF PART OF CROWN PORTION 55
PARISH OF JIKA JIKA
COUNTY OF BOURKE

SCALE OF FEET

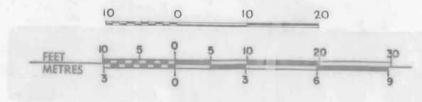

FEET	METRES	FEET	METRES
0.12	0.037	35.00	10.058
0.25	0.076	35.12	10.095
0.33	0.101	35.25	10.135
0.38	0.116	35.35	10.165
0.75	0.229	35.60	10.241
5.83	1.777	57.38	17.489
6.04	1.841	61.33	18.693
6.15	1.875	65.08	19.227
6.21	1.895	65.50	19.364
6.29	1.917	80.21	24.448
7.36	2.249	86.08	26.237
7.54	2.298	102.38	31.205
7.58	2.310	307.00	93.974
7.75	2.362		
8.73	2.661		
8.79	2.679		
9.00	2.743		
14.50	4.420		
14.62	4.456		
14.67	4.471		
14.92	4.548		
15.17	4.624		
17.54	5.346		
18.08	5.511		
24.71	7.532		
24.96	7.608		
28.32	8.615		
28.96	8.827		

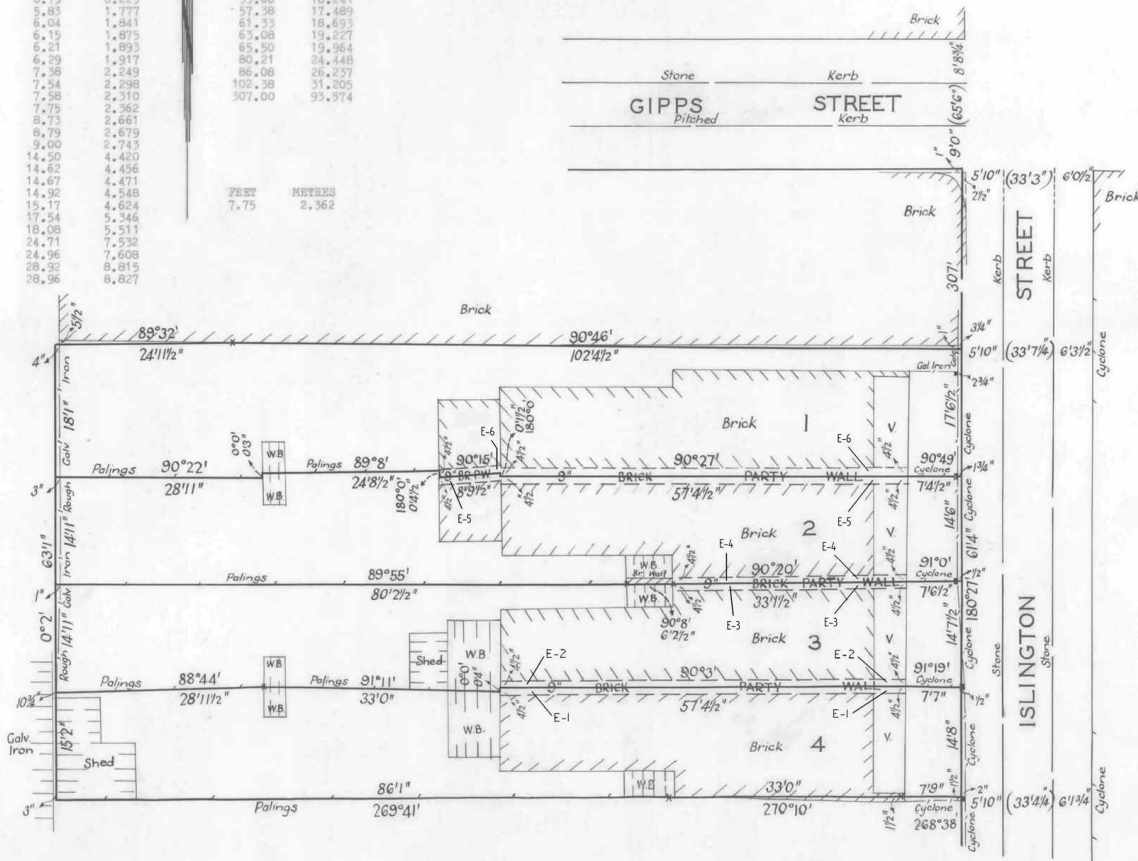

COLOUR CODE
E-5, E-3 & E-1= BLUE
E-6, E-4 & E-2= YELLOW

LP 30569

30569
30569

REF. 11170

LX 11
AC B

FOR APPROPRIATIONS ETC.
SEE BACK HEREOF

LP 30569

Conceder dda v

SUBDIVISIONAL
 CERTIFICATE OF TITLE V. 6350 F. 924

**FOR TITLE REFERENCES TO LOTS
 SEE PARCELS INDEX**

LODGED BY C.T. Erland

DEALING No. 5555504 DATE 3 / 5 / 54

DECLARED BY R.D. Steele

ON 21 / 7 / 55

COUNCIL Stat. Dec. in Liew of ED's Report.

DATE OF CONSENT / /

PLAN MAY BE LODGED 25 / 7 / 55

PLAN APPROVED. DATE / / TIME a.m.
 p.m.

The land coloured yellow and blue
 is appropriated or set apart for
 easements of party wall.

NOTATIONS

AS TO THE LAND MARKED E-1 AND E-4 RESPECTIVELY:
 TOGETHER WITH A RIGHT TO USE THE LAND MARKED E-2 AND E-3
 RESPECTIVELY ON THE MAP FOR PARTY WALL PURPOSES

AS TO LOT 3:
 TOGETHER WITH A RIGHT TO USE THE LAND MARKED E-1 AND E-4
 ON THE MAP FOR PARTY WALL PURPOSES

ENCUMBRANCES

AS TO THE LAND MARKED E-1 AND E-4:
 THE PARTY WALL EASEMENTS CREATED BY TRANSFER 2680324

AS TO THE LAND MARKED E-2 AND E-3
 ANY EASEMENTS AFFECTING THE SAME

THIS IS THE BACK OF LP 30569

LIST OF MODIFICATIONS				
LAND	MODIFICATION	DEALING No.	A.R.T	EDN. No.
	APPURTENANT EASEMENTS	<u> </u>		2
	CREATION OF EASEMENTS	<u> </u>		2

PHOTOGRAPHED AT CENTRAL PLAN OFFICE

SIZE DATE

COLOURED dh CHECKED JL Chambers

POSTED dh CHECKED JL Chambers

11437/72

Appendix B

DELWP Planning Property Report

From www.planning.vic.gov.au at 01 October 2020 11:28 AM

PROPERTY DETAILS

Address: **99-117 ISLINGTON STREET COLLINGWOOD 3066**

Lot and Plan Number: **More than one parcel - see link below**

Standard Parcel Identifier (SPI): **More than one parcel - see link below**

Local Government Area (Council): **YARRA**

Council Property Number: **103265**

Planning Scheme: **Yarra**

Directory Reference: **Melway 2C G11**

www.yarracity.vic.gov.au

[Planning Scheme - Yarra](#)

This property has 6 parcels. For full parcel details get the free Property report at [Property Reports](#)

UTILITIES

Rural Water Corporation: **Southern Rural Water**

Melbourne Water Retailer: **City West Water**

Melbourne Water: **Inside drainage boundary**

Power Distributor: **CITIPOWER**

[View location in VicPlan](#)

STATE ELECTORATES

Legislative Council: **NORTHERN METROPOLITAN**

Legislative Assembly: **RICHMOND**

Planning Zones

COMMERCIAL 2 ZONE (C2Z)

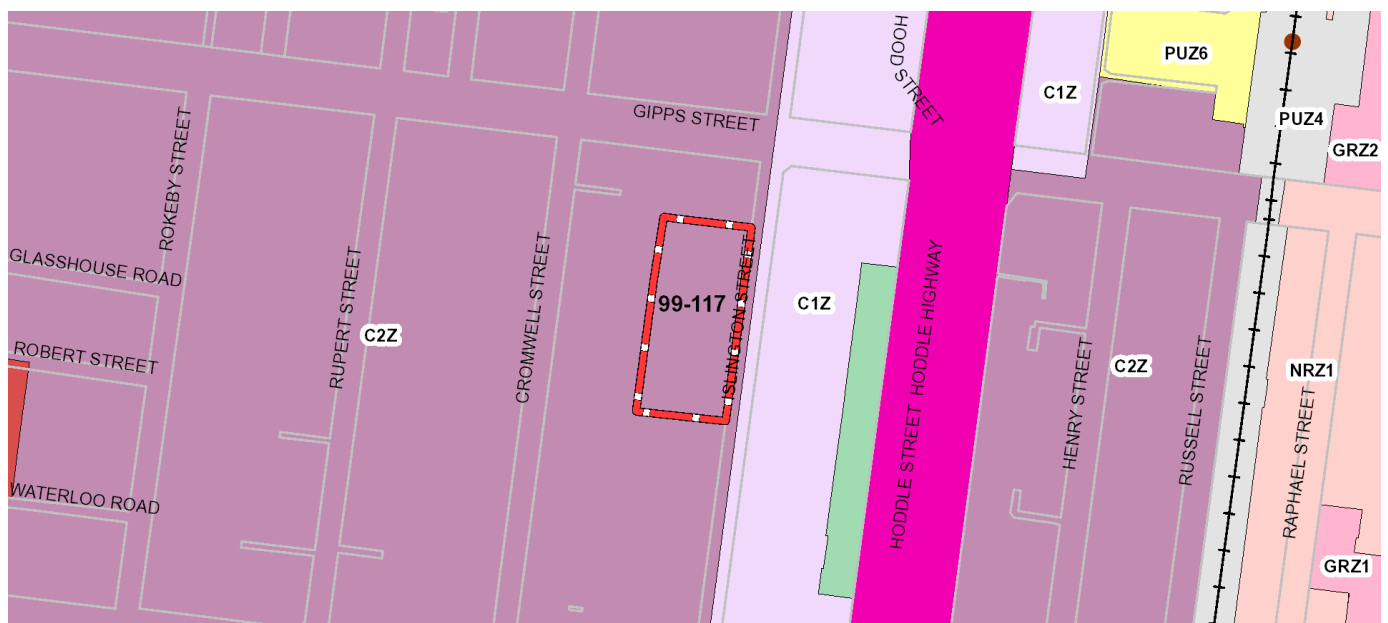

Note: labels for zones may appear outside the actual zone - please compare the labels with the legend.