

Register Search Statement - Volume 10357 Folio 001

Copyright State of Victoria. This publication is copyright. No part may be reproduced by any process except in accordance with the provisions of the Copyright Act 1968 (Cth) and for the purposes of Section 32 of the Sale of Land Act 1962 (Vic) or pursuant to a written agreement. The information is only valid at the time and in the form obtained from the LANDATA REGD TM System. None of the State of Victoria, LANDATA REGD TM System, Victorian Land Registry Services Pty. Ltd. ABN 86 627 986 396 as trustee for the Victorian Land Registry Services Trust ABN 83 206 746 897 accept responsibility for any subsequent release, publication or reproduction of the information.

REGISTER SEARCH STATEMENT (Title Search) Transfer of Land Act 1958

VOLUME 10357 FOLIO 001  
No CofT exists

Security no : 124082795482P  
Produced 27/04/2020 02:54 PM

LAND DESCRIPTION

Common Property on Plan of Subdivision 409682R.  
PARENT TITLE Volume 10323 Folio 100  
Created by instrument PS409682R 28/11/1997

REGISTERED PROPRIETOR

Estate Fee Simple  
Sole Proprietor

OWNERS CORPORATION PLAN NO. PS409682R of "MELLINGTON MANAGEMENT T/AS SELECT OWNERSCORP MANAGEMENT" 711 HIGH STREET KEW EAST VIC 3102  
PS409682R 28/11/1997

ENCUMBRANCES, CAVEATS AND NOTICES

Any encumbrances affecting Common Property that are derived from an encumbrance shown on titles to lots affected by the Owners Corporation.

Any encumbrances created by Section 98 Transfer of Land Act 1958 or Section 24 Subdivision Act 1988 and any other encumbrances shown or entered on the plan set out under DIAGRAM LOCATION below.

DIAGRAM LOCATION

SEE PS409682R FOR FURTHER DETAILS AND BOUNDARIES

ACTIVITY IN THE LAST 125 DAYS

NIL

-----END OF REGISTER SEARCH STATEMENT-----

Additional information: (not part of the Register Search Statement)

OWNERS CORPORATIONS

The land in this folio is affected by  
OWNERS CORPORATION PLAN NO. PS409682R

DOCUMENT END

**Delivered from the LANDATA® System by SAI Global Property Division Pty Ltd  
Delivered at 27/04/2020, for Order Number 62008714. Your reference: 2019544.**

<b>PLAN OF SUBDIVISION</b>	Stage No. <hr/>	LTO use only <b>EDITION 2</b>	Plan Number <b>PS 409682R</b>
----------------------------	--------------------	----------------------------------	----------------------------------

**Location of Land**

**Parish:** JIKA JIKA

**Township:**

**Section:**

**Crown Allotment:**

**Crown Portion:** 54 (PART)

**LTO Base Record:** CHART 72

**Title Reference:** VOL 10323 FOL 100

**Last Plan Reference:** PS 406050X (LOT 2)

**Postal Address:** 83-97 ROKEBY STREET  
(at time of subdivision) COLLINGWOOD

**AMG Co-ordinates** E 322700 Zone: 55  
(of approx. centre of land in plan) N 5813600

**Council Certification and Endorsement**

**Council Name:** YARRA CITY COUNCIL **Ref:** 97/825

- ~~This plan is certified under section 6 of the Subdivision Act 1988.~~
- This plan is certified under section 11(7) of the Subdivision Act 1988.  
Date of original certification under section 6 30/10/97
- This is a statement of compliance issued under section 21 of the Subdivision Act 1988.

**OPEN SPACE**

(i) A requirement for public open space under section 18 of the Subdivision Act 1988 ~~has/has not been made.~~

(ii) ~~The requirement has been satisfied.~~

(iii) ~~The requirement is to be satisfied in Stage.....~~

~~Council Delegate~~  
~~Council Seal~~  
 Date       /      /      

Re-certified under section 11(7) of the Subdivision Act 1988

Council Delegate  
~~Council Seal~~  
 Date 11/11/97

**Vesting of Roads and/or Reserves**

Identifier	Council/Body/Person
NIL	NIL

**Notations**

**Staging** This ~~is~~/is not a staged subdivision Planning Permit No.

**Depth Limitation** DOES NOT APPLY

Boundaries shown by thick continuous lines are defined by buildings

Location of boundaries defined by buildings:

└ Median: BOUNDARIES SHOWN THUS

└ Exterior Face: BOUNDARIES SHOWN THUS

The Common Property is all the land in the plan except lots 1 to 12

**Survey** This plan is/~~is not~~ based on survey

This survey has been connected to permanent marks no(s) MMB409 MMB534 In Proclaimed Survey Area No. -

**Easement Information**

Section 12(2) of the Subdivision Act 1988 applies to all the land in this plan

**Legend:** E - Encumbering Easement, Condition in Crown Grant in the Nature of an Easement or Other Encumbrance      A - Appurtenant Easement  
 R - Encumbering Easement (Road)

Subject Land	Purpose	Width (metres)	Origin	Land Benefited/In Favour Of

**LTO use only**

Statement of Compliance/  
Exemption Statement

Received

Date 17/11/97

**LTO use only**

PLAN REGISTERED

TIME 9:20

DATE 28/11/97

Assistant Registrar of Titles

Sheet 1 of 3 sheets

**WBCM group**

Engineers  
Surveyors  
Planners

WBCM Surveys Pty Ltd A.C.N. 008 837608  
 71 Palmerston Crescent South Melbourne Victoria 3206 Australia  
 PO Box 248 South Melbourne 3206 DT 80584 Strevick Bldg  
 Fax 03 9588 6382 Telephone 03 9588 1400

LICENSED SURVEYOR (PRINT) GEOFFREY JAMES TURNER

SIGNATURE ..... DATE 17/10/97

REF 6257003      14/10/97      VERSION C

DWG 625700AC

DATE 11/11/97

COUNCIL DELEGATE SIGNATURE

Original sheet size A3

Printer: Trusec LDP/2/97a Metric: Trusec B/1/1/97

**PLAN OF SUBDIVISION**

Stage No. \_\_\_\_\_

Plan Number

**PS 409682R**

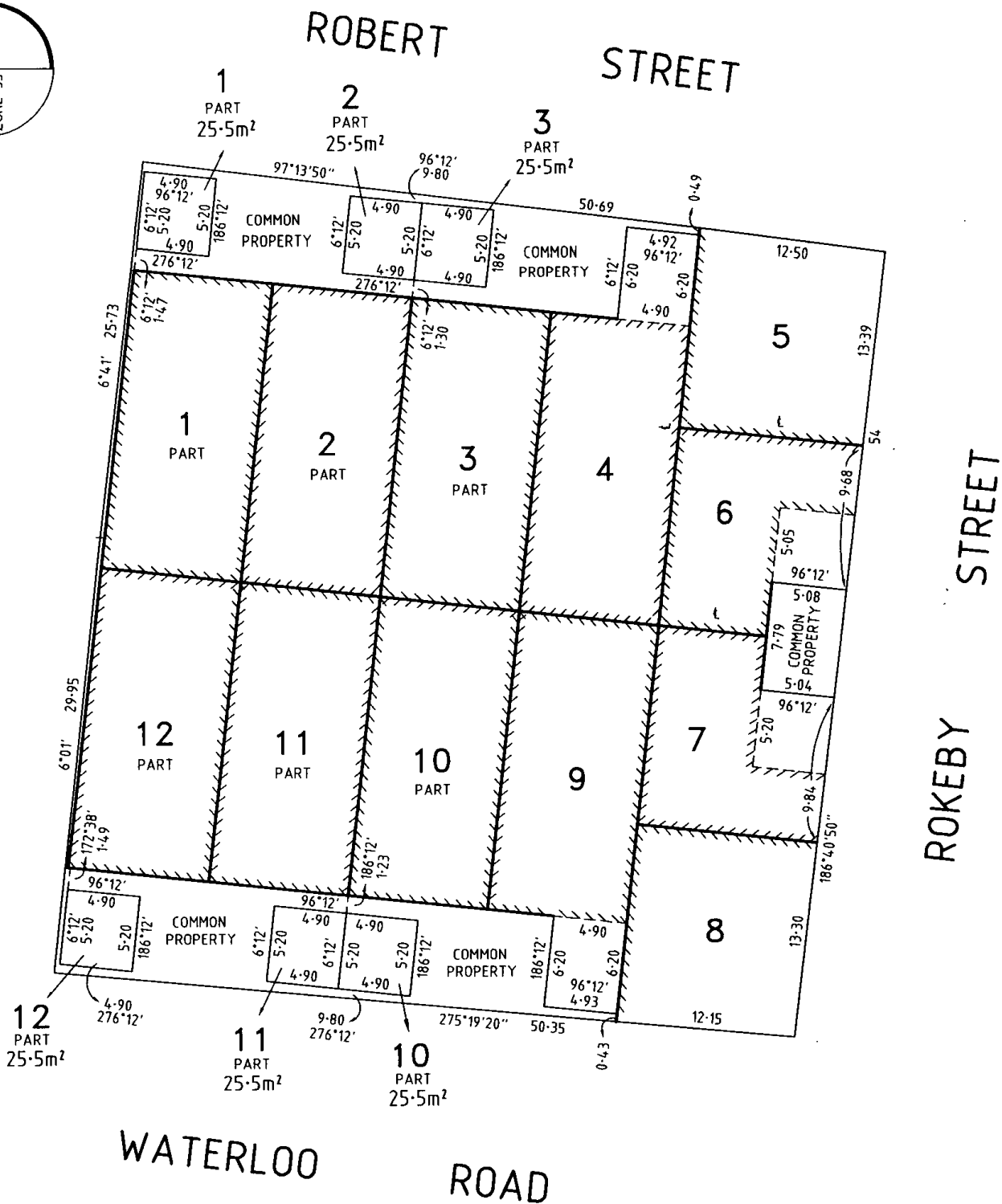
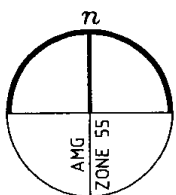

WBCM Surveys Pty Ltd ACN 006 937506  
 71 Palmerston Crescent South Melbourne Victoria 3205 Australia  
 PO Box 243 South Melbourne 3205 DX20524 Emerald Hill  
 Facsimile 03) 9699 5992 Telephone 03) 9699 1400

ORIGINAL

SCALE

SCALE  
1:300

SHEET  
SIZE  
A3



LENGTHS ARE IN METRES

LICENSED SURVEYOR (PRINT) GEOFFREY JAMES TURNER

SIGNATURE \_\_\_\_\_ DATE 17 / 10 / 97

REF 6257003 14/10/97 VERSION C  
 DWG 625700AC

Sheet 2 of 3 sheets

DATE 11 / 11 / 97

COUNCIL DELEGATE SIGNATURE

Original sheet size A3

PS409682R

FOR CURRENT BODY CORPORATE DETAILS  
SEE BODY CORPORATE SEARCH REPORT





# Department of Environment, Land, Water & Planning

## Owners Corporation Search Report

Copyright State of Victoria. This publication is copyright. No part may be reproduced by any process except in accordance with the provisions of the Copyright Act 1968 (Cth) and for the purposes of Section 32 of the Sale of Land Act 1962 (Vic) or pursuant to a written agreement. The information is only valid at the time and in the form obtained from the LANDATA REGD TM System. None of the State of Victoria, LANDATA REGD TM System, Victorian Land Registry Services Pty. Ltd. ABN 86 627 986 396 as trustee for the Victorian Land Registry Services Trust ABN 83 206 746 897 accept responsibility for any subsequent release, publication or reproduction of the information.

Produced: 27/04/2020 02:55:15 PM

**OWNERS CORPORATION  
PLAN NO. PS409682R**

The land in PS409682R is affected by 1 Owners Corporation(s)

### Land Affected by Owners Corporation:

Common Property, Lots 1 - 12.

### Limitations on Owners Corporation:

Unlimited

### Postal Address for Services of Notices:

MELLINGTON MANAGEMENT T/AS SELECT OWNERSCORP MANAGEMENT 711 HIGH STREET KEW EAST VIC 3102

AF835920J 21/05/2008

### Owners Corporation Manager:

NIL

### Rules:

Model Rules apply unless a matter is provided for in Owners Corporation Rules. See Section 139(3) Owners Corporation Act 2006

### Owners Corporation Rules:

NIL

### Additional Owners Corporation Information:

NIL

### Notations:

NIL

### Entitlement and Liability:

NOTE – Folio References are only provided in a Premium Report.

Land Parcel	Entitlement	Liability
Common Property	0	0
Lot 1	9	9
Lot 2	9	9
Lot 3	9	9
Lot 4	9	9
Lot 5	7	7
Lot 6	7	7



# Department of Environment, Land, Water & Planning

## Owners Corporation Search Report

Produced: 27/04/2020 02:55:15 PM

**OWNERS CORPORATION  
PLAN NO. PS409682R**

### Entitlement and Liability:

NOTE – Folio References are only provided in a Premium Report.

Land Parcel	Entitlement	Liability
Lot 7	7	7
Lot 8	7	7
Lot 9	9	9
Lot 10	9	9
Lot 11	9	9
Lot 12	9	9
<b>Total</b>	<b>100.00</b>	<b>100.00</b>

From 31 December 2007 every Body Corporate is deemed to be an Owners Corporation. Any reference to a Body Corporate in any Plan, Instrument or Folio is to be read as a reference to an Owners Corporation.

Statement End.